

WINDOWS AND DOORS HARDWARE

fapim[®]
Life in evolution

 Made in Italy





**WINDOWS
AND DOORS
HARDWARE**

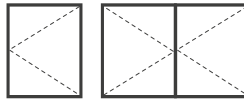

The AAMA 513

Standard laboratory test method for determination of forces and motions required to activate operable parts of CW and AW class operable windows, sliding glass doors and terrace doors in accessible spaces addresses the necessary window-specific provisions



NEW YORK CITY DEPARTMENT OF
HEALTH AND MENTAL HYGIENE

HDL# 03-11-2016

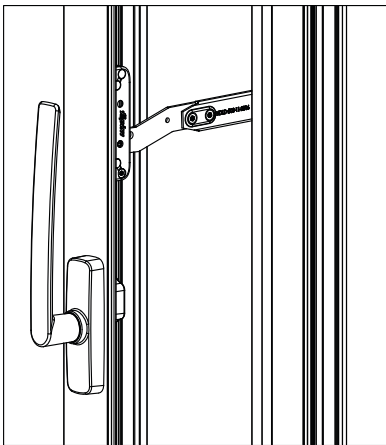
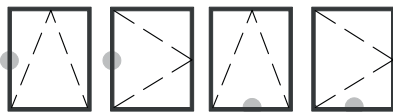

ADA certified

Adjustable mechanism
-0,787" +0,787"

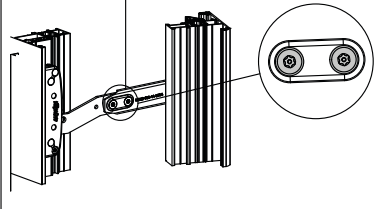

Safety screws TSP M5x0,255"
TORX TX25+PIN stainless steel

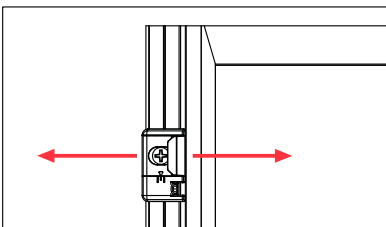

Adjustable keeper

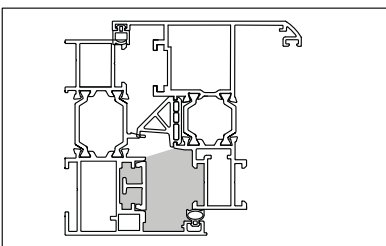

Available for C.E. groove

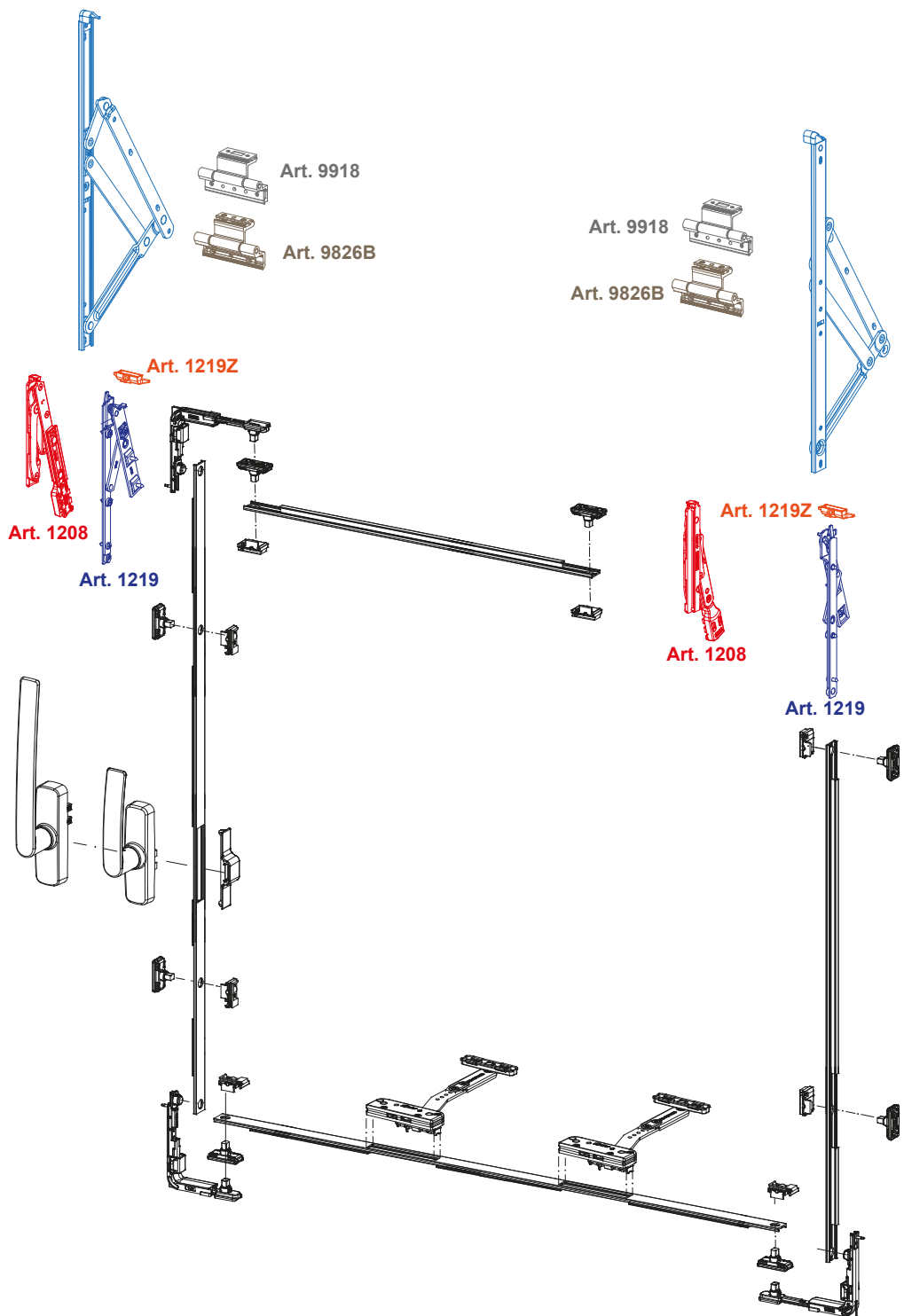

1219
1219Z

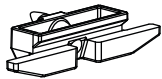

Art.1219Z

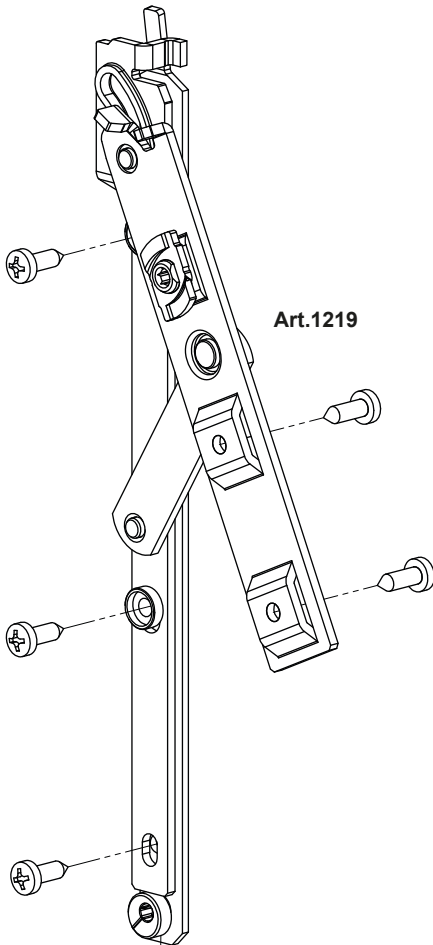

Art.1219

OUT

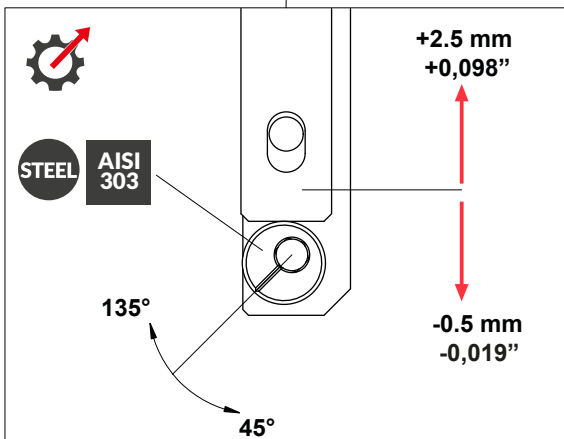
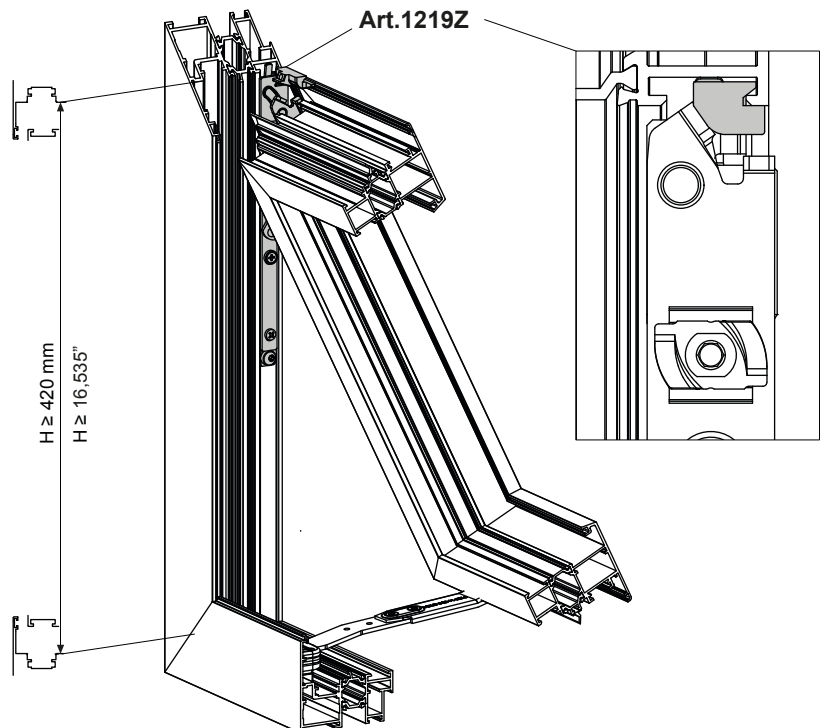
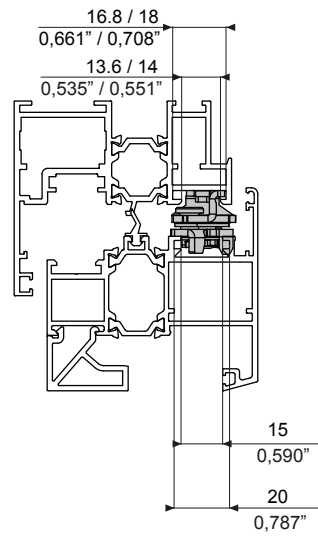

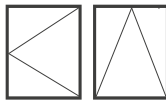

NYC

HDLD #07-03-2017

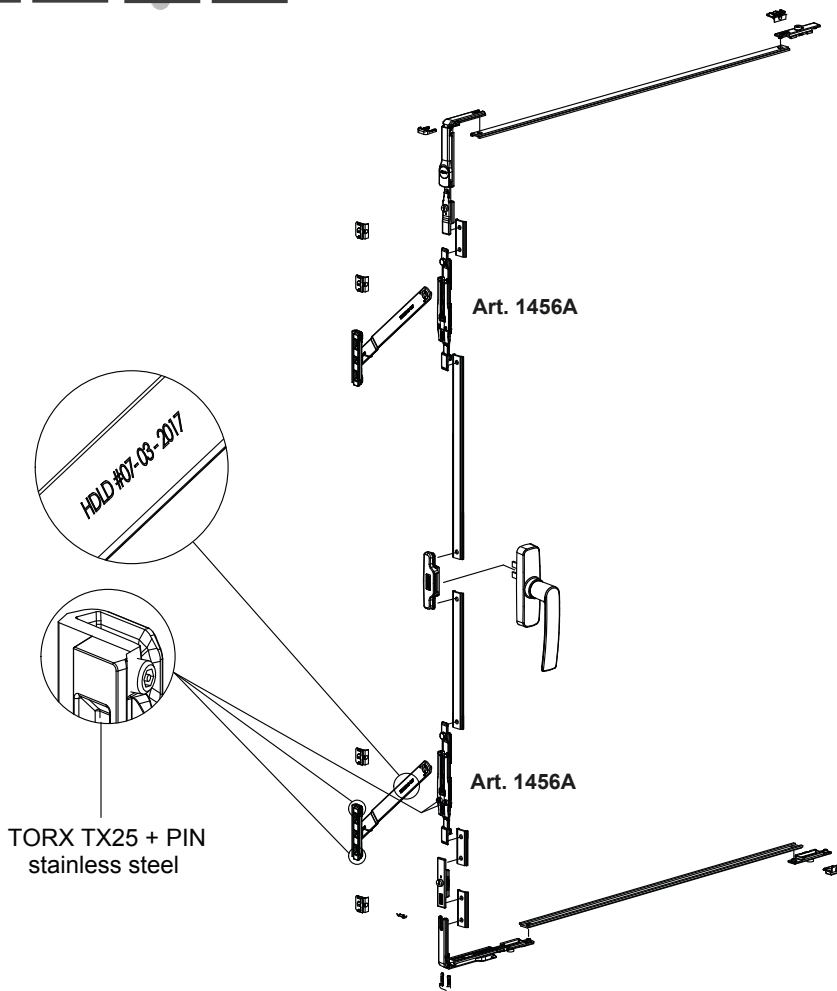
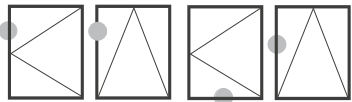

TORX TX25 + PIN
stainless steel

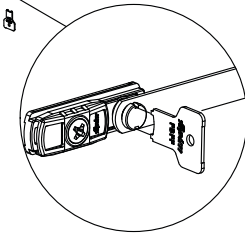
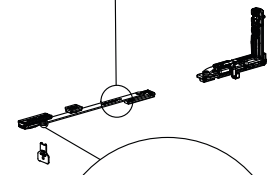
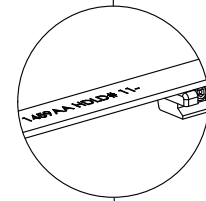

A	B
1,968"	4,724"
2,362"	4,330"
2,755"	3,937"
3,149"	3,543"

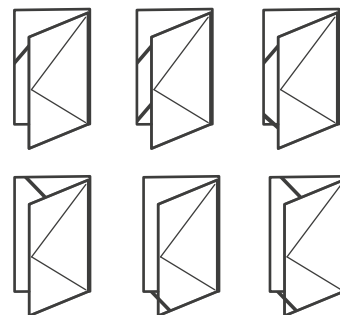
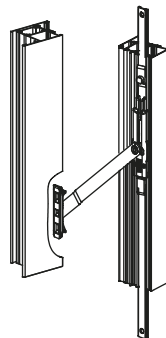
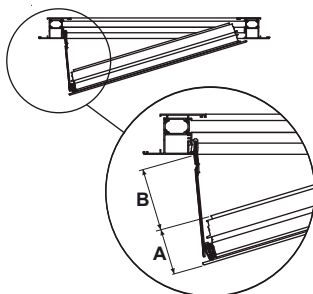

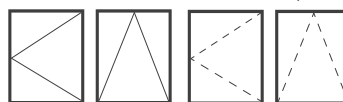

AAMA 904-01

Voluntary specification for multi-bar hinges
in window applications

Art. 1457C



AAMA 907-05

Voluntary specification for corrosion
resistant coatings on carbon steel components

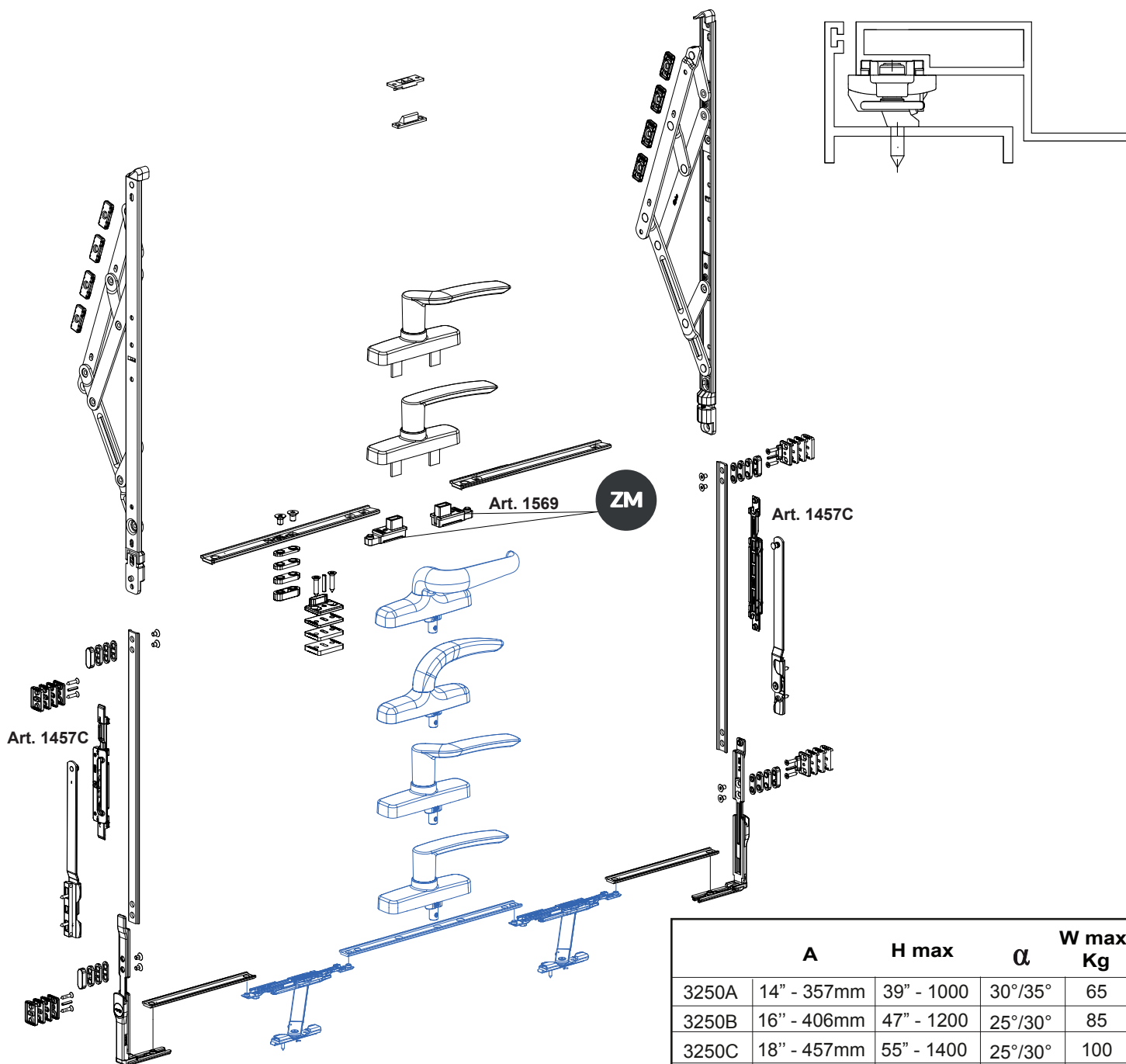

	A	H max	α	W max Kg
3250A	14" - 357mm	39" - 1000	30°/35°	65
3250B	16" - 406mm	47" - 1200	25°/30°	85
3250C	18" - 457mm	55" - 1400	25°/30°	100
3250D	20" - 511mm	63" - 1600	20°/25°	110
3250F	24" - 601mm	71" - 1800	15°/20°	120
3250H	28" - 708mm	79" - 2000	15°/20°	130

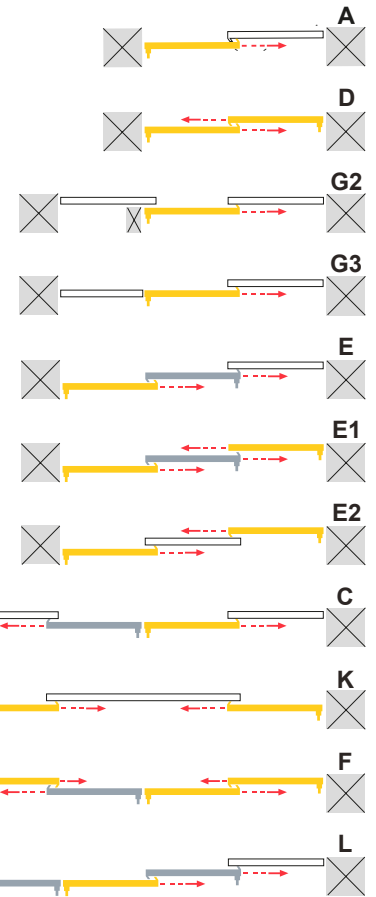
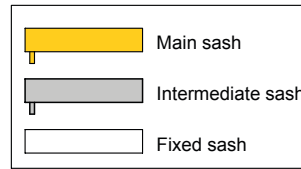
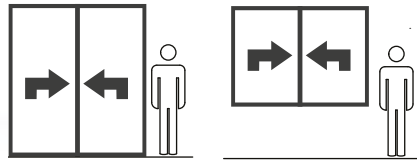

<p>lb 550 Max W ≥ 28,740"-133,858"</p>	
<p>lb 880 Max W ≥ 52,362"-149,606"</p>	
<p>lb 726 Max W ≥ 28,740"-133,858"</p>	
<p>lb 968 Max W ≥ 52,362"-149,606"</p>	

MAGICUBE 180

TILT AND TURN MECHANISM

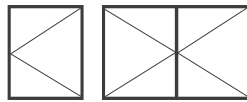

396 lb

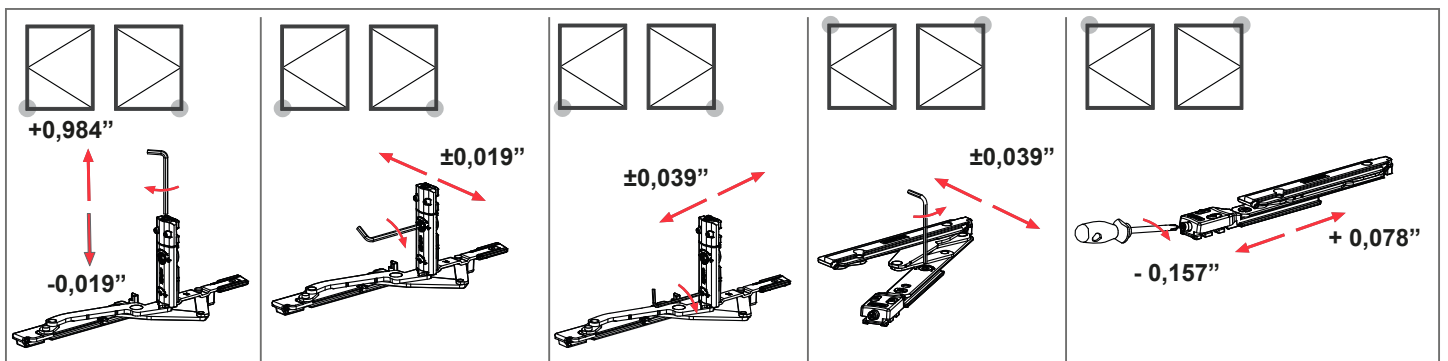
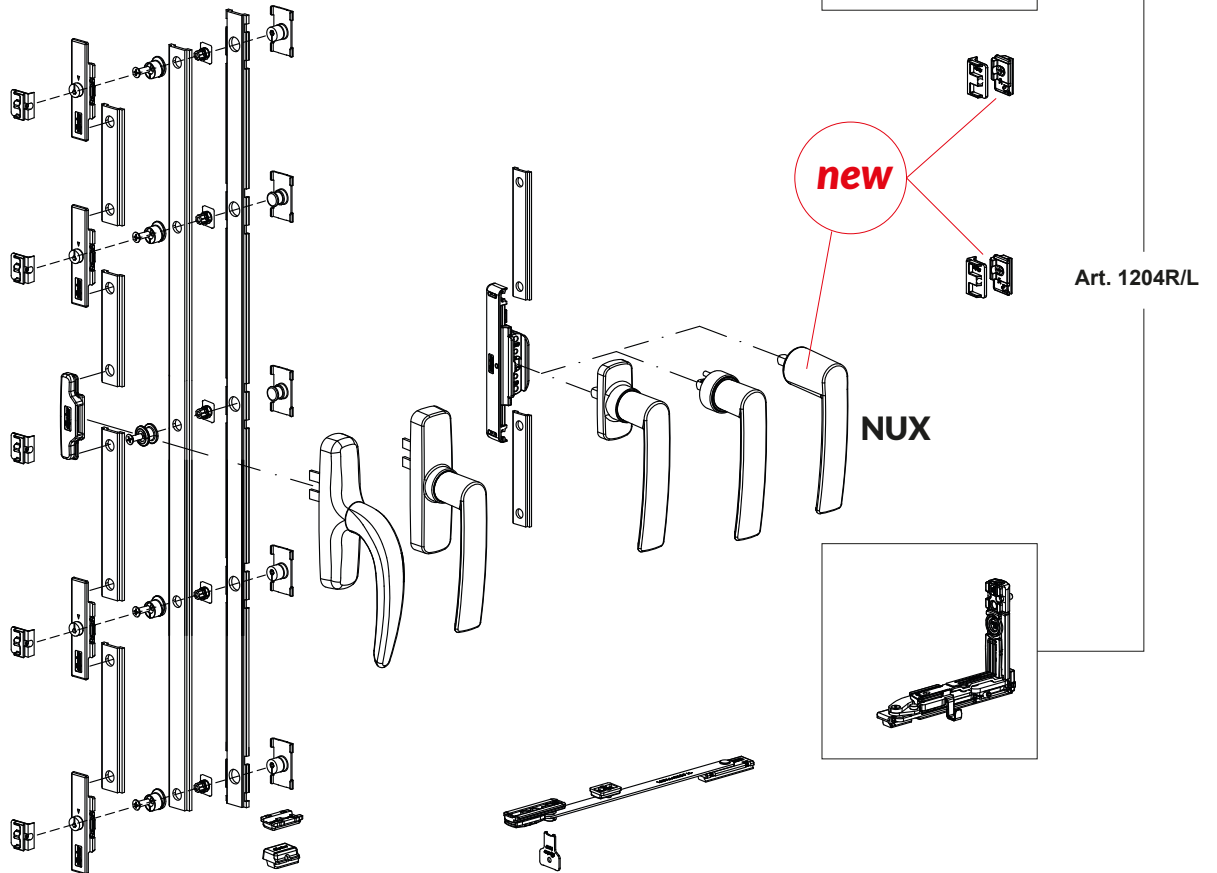
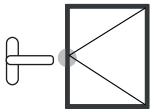

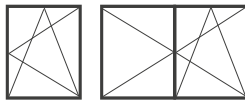
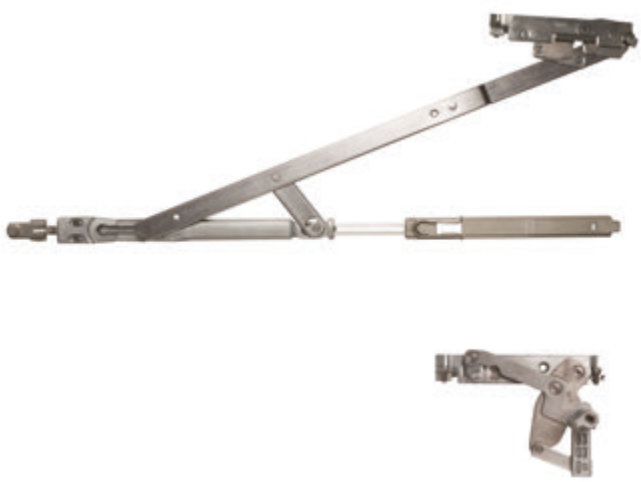

MAGICUBE 130

TILT AND TURN MECHANISM



286 lb

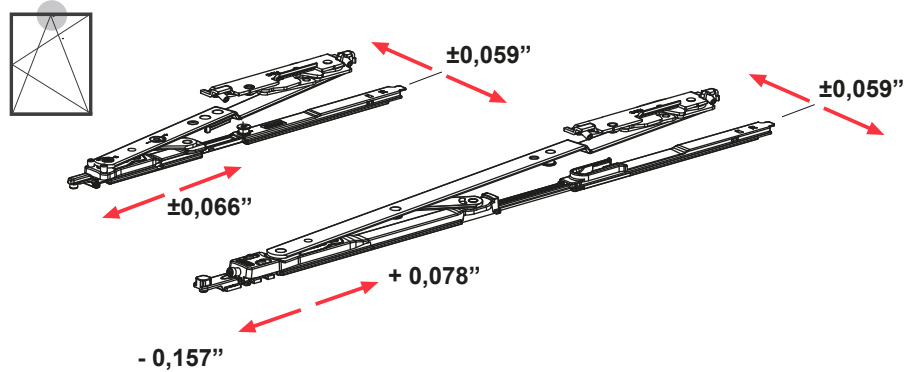
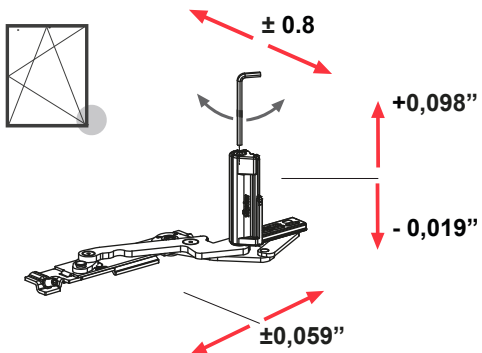
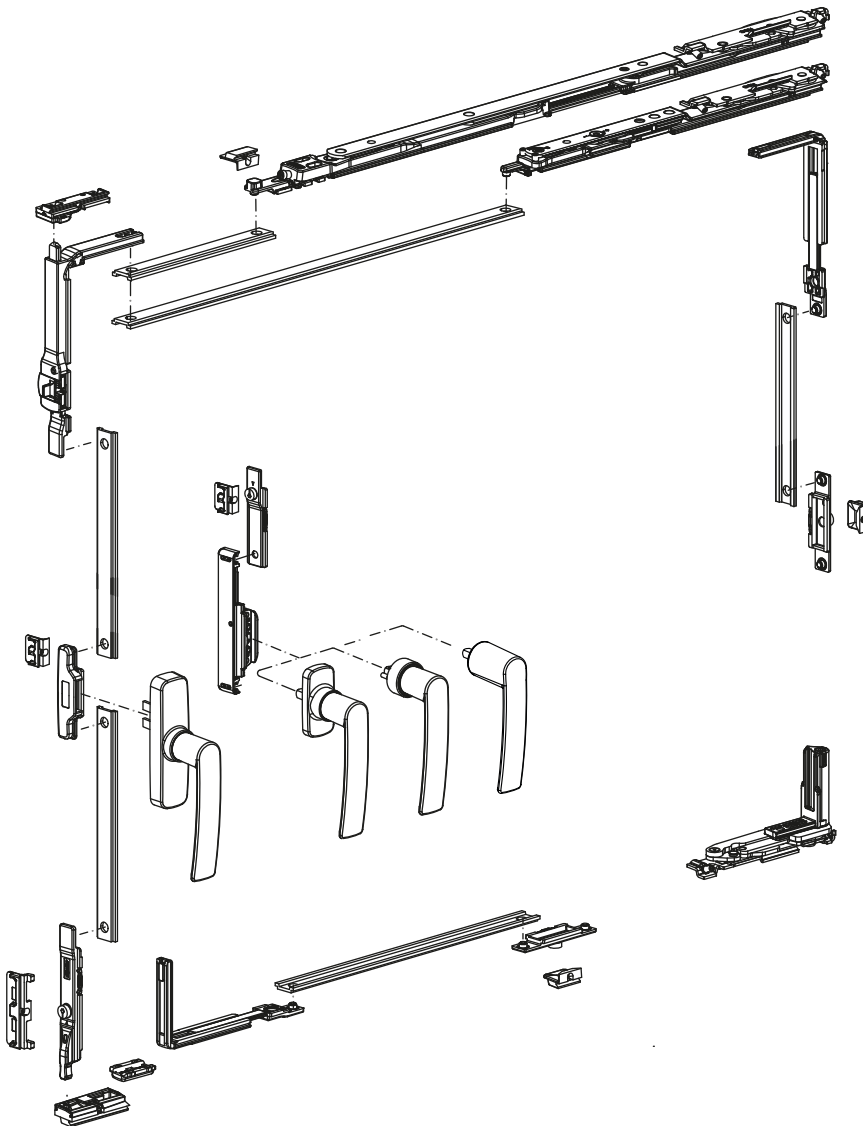
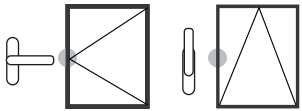

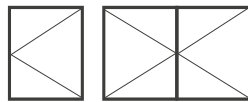

MAGICUBE 130

TILT AND TURN MECHANISM



286 lb

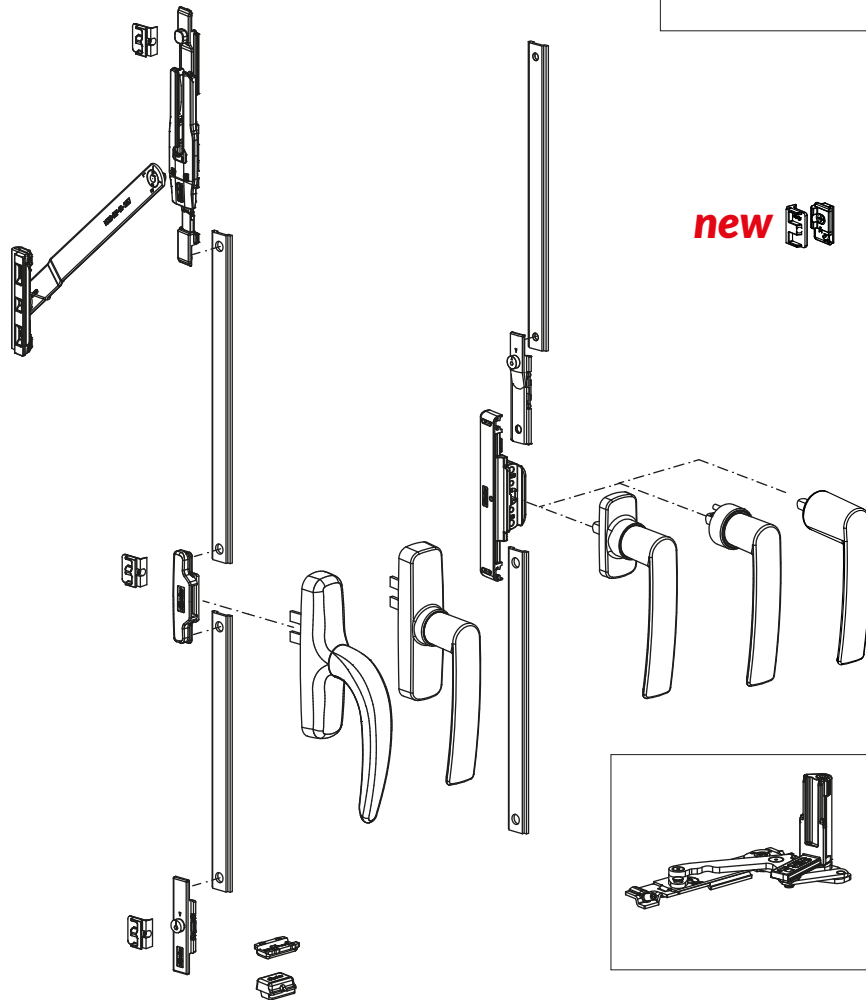
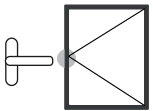

new

Art. 1214R/L

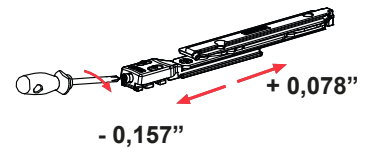
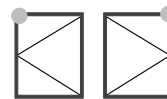
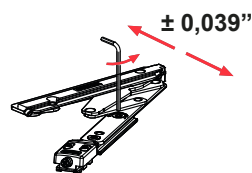
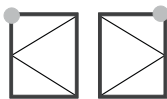
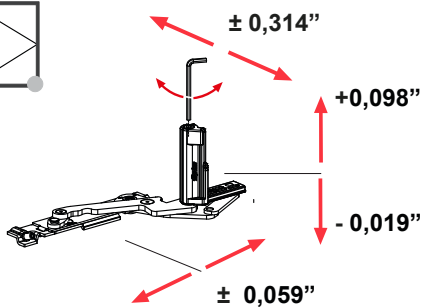
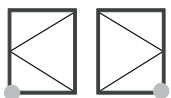

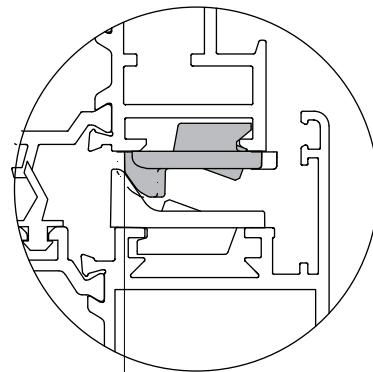
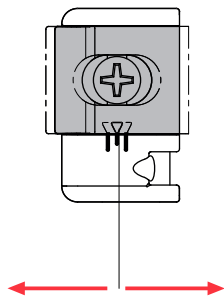
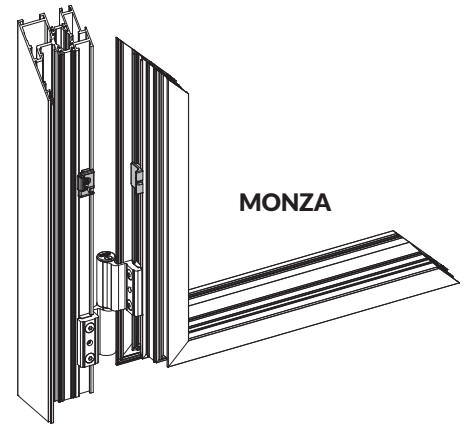
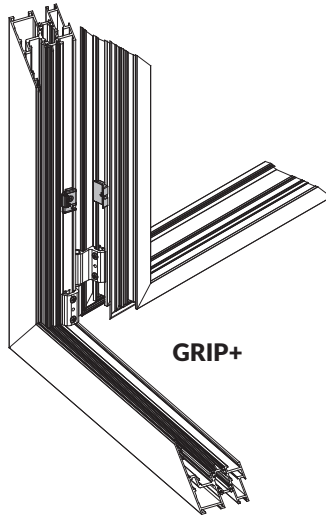
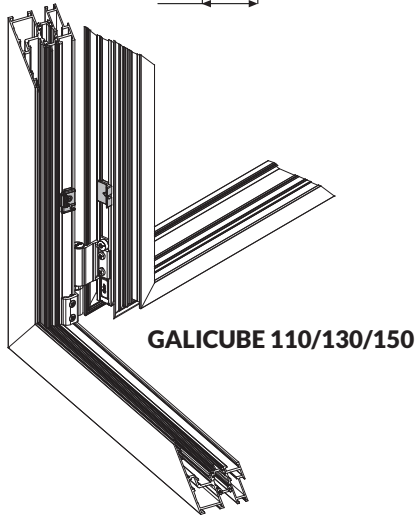
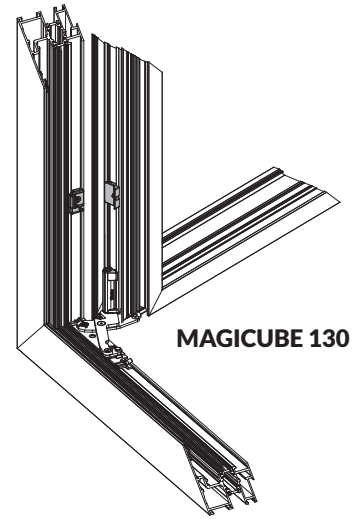
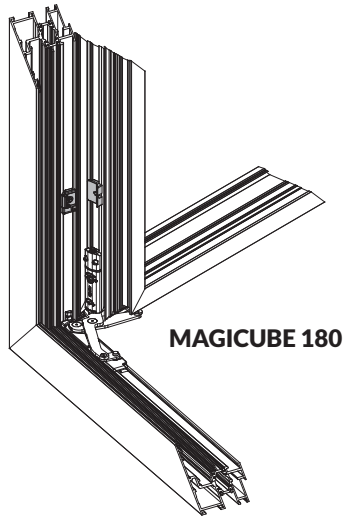
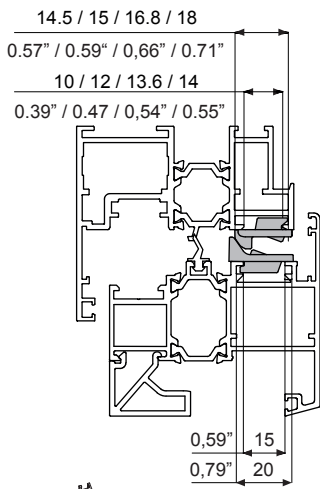
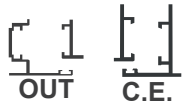
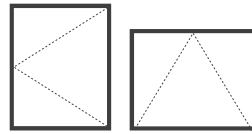

-1.5 mm
-0,06" ← → +1.5 mm
+0,06"

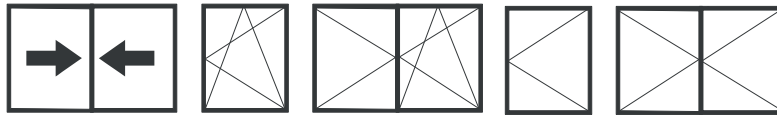

Art. 0505A

Art. 0507AZ

Art. 0509AL/AR

Art. 0508A



PATENTED

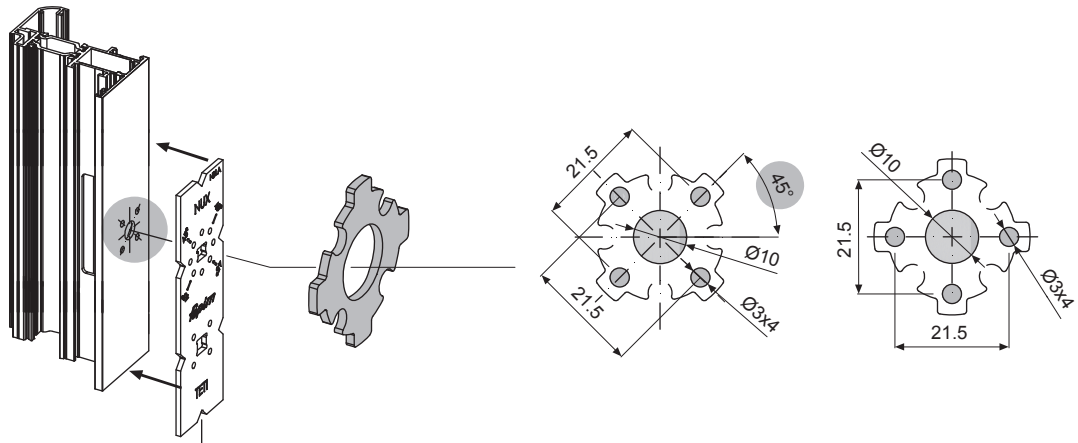

Art. 2106

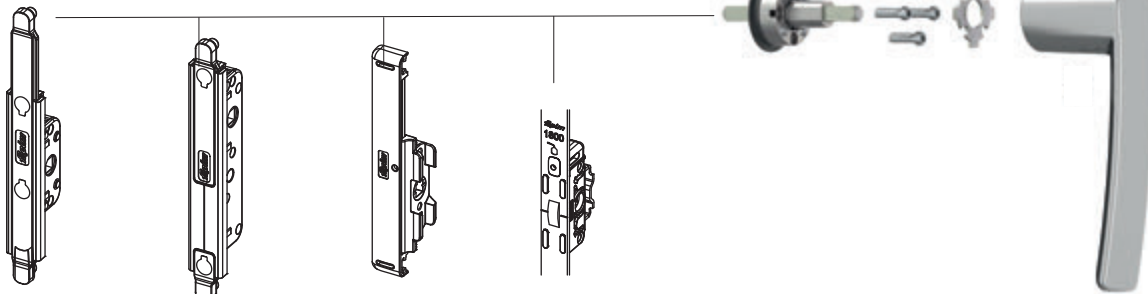

Art. 0651A

Art. 0652A

Art. 0520

FORMULA

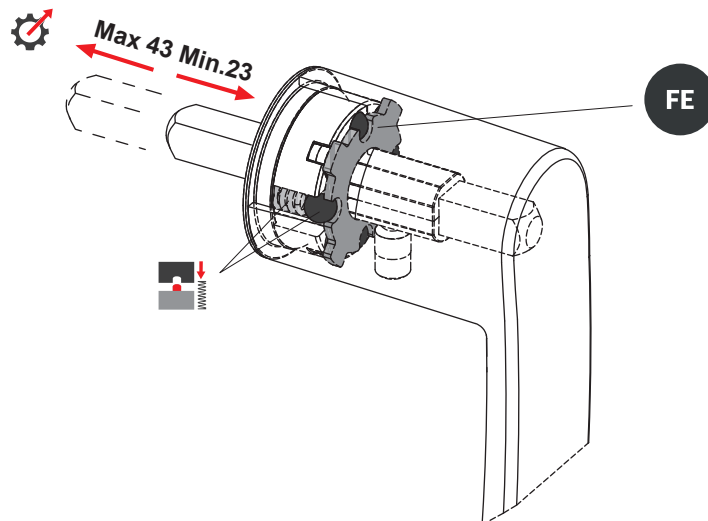

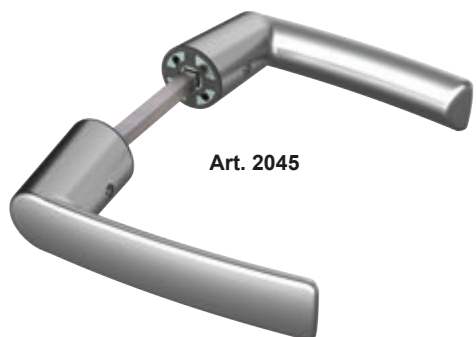
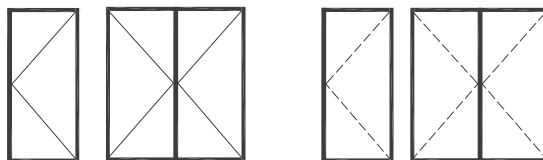

Art. 2045

Art. 2046



PATENTED

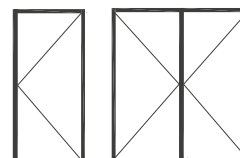
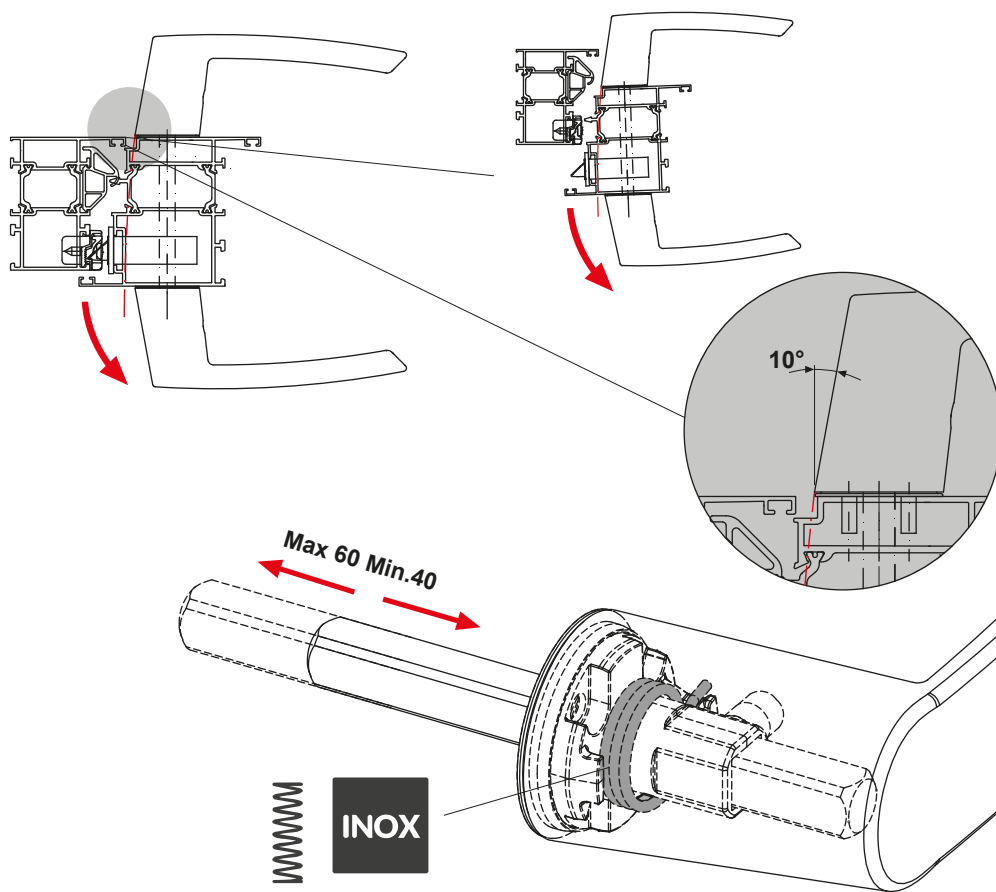
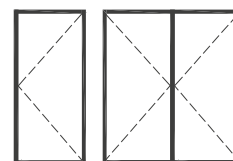
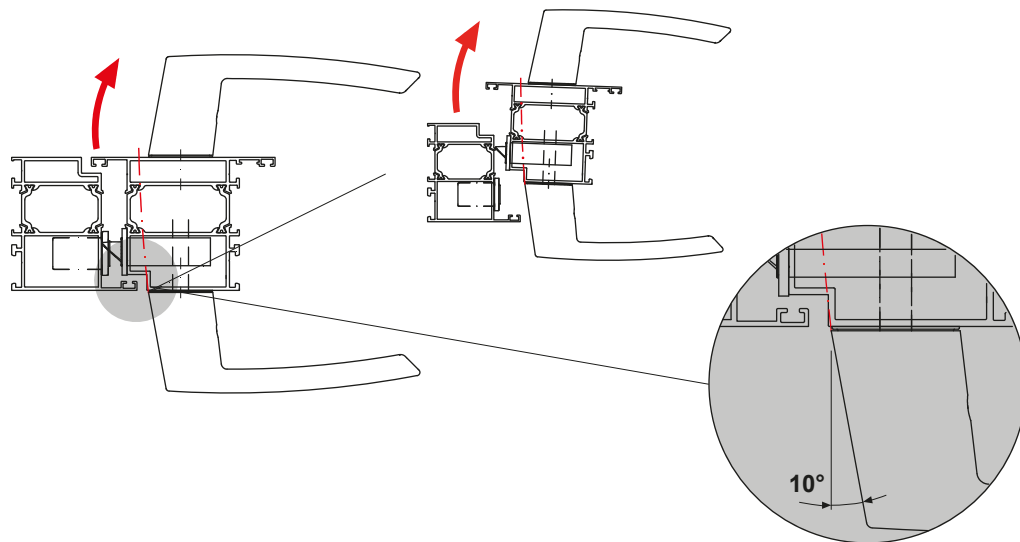



OLTRE
PANIC EXIT DEVICE



CE¹⁸
0497

EN 1125:2008

OLTRE was tested according to

UNI EN 1363-1:2012 / UNI EN 1634-1:2018 european standards.

The fire test was passed, and it was assigned the EI 90 class of resistance.

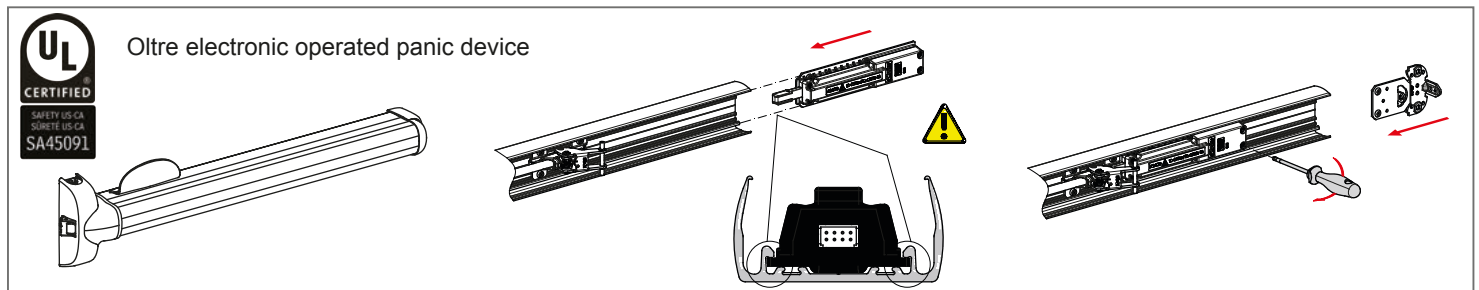
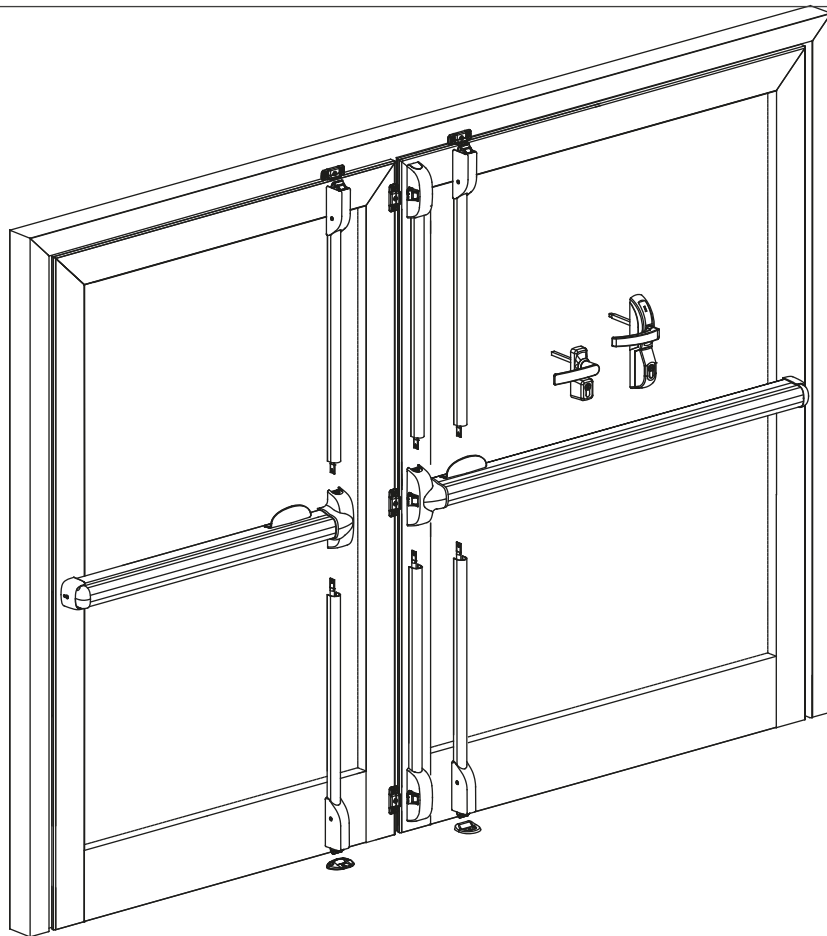
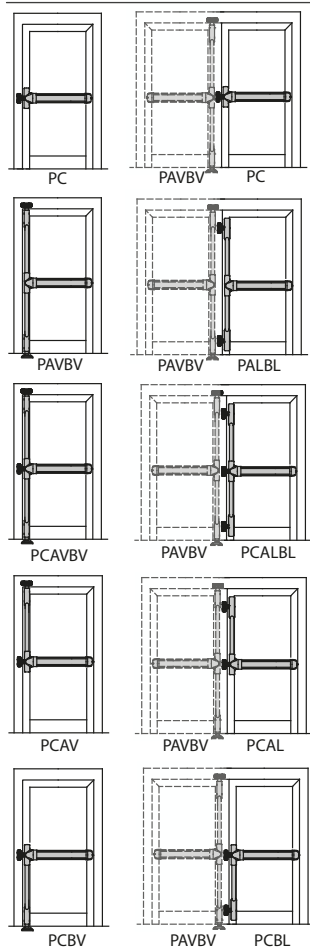

Oltre electronic operated panic device



CLEAN HAND is Fapim's new antibacterial surface finish.

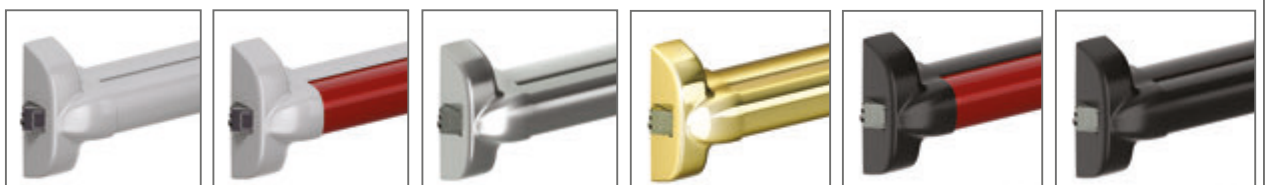

G6-SILVER SGL - G6-SILVER SGL G6-SILVER SGL - 71-RAL 3003 03-INOX PVD - 03-INOX PVD 16-GOLD PVD - 16-GOLD PVD 37-9005 MAT - 71-RAL 3003 37-9005 MAT - 37-9005 MAT

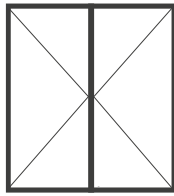

MONZA
DOOR HINGE



264 lb
5.000.000 cycles
PATENTED



DoP 015-CPR-2018
EN 1935:2002 / AC:2003

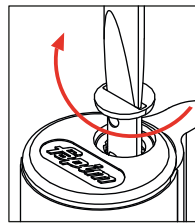
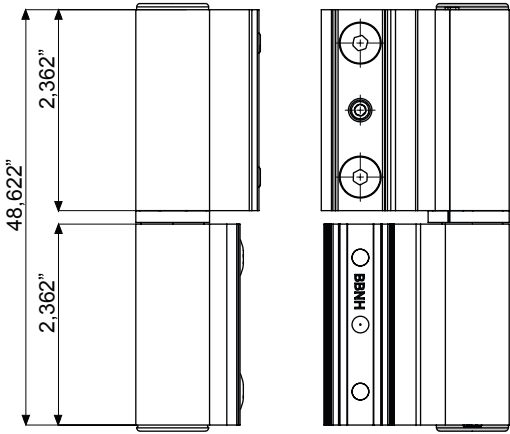
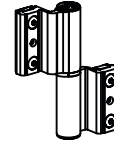

Screw cap directly fastened on the pin

Counterplate in extruded aluminium with central safety hole

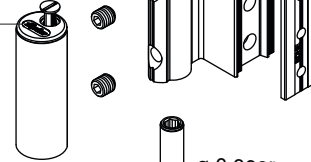

STEEL **INOX**

ø0,393" eccentric pin in stainless steel

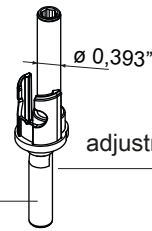

Horizontal micrometric adjustment with the door closed

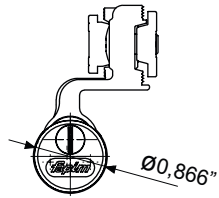

Bush in Delrin for pressure adjustment

Grub screw for vertical adjustment with the door closed

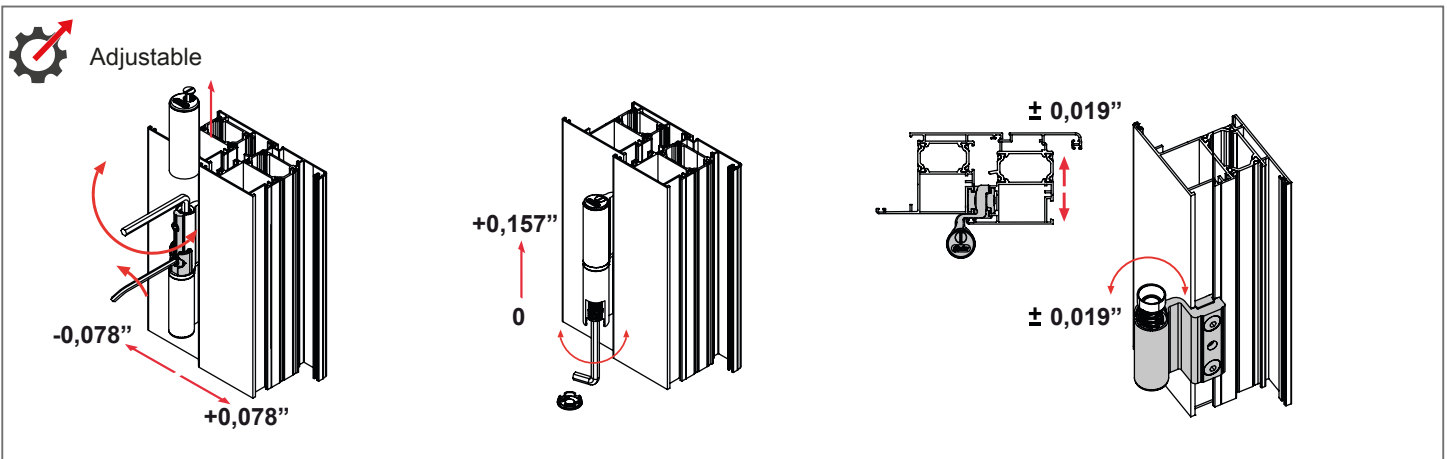
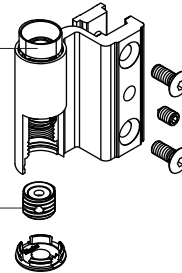

MONZA
DOOR HINGE



330 lb

PATENTED



DoP 030-CPR-2021
EN 1935:2002 / AC:2003

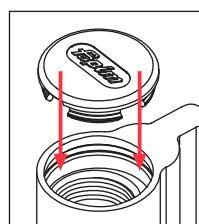
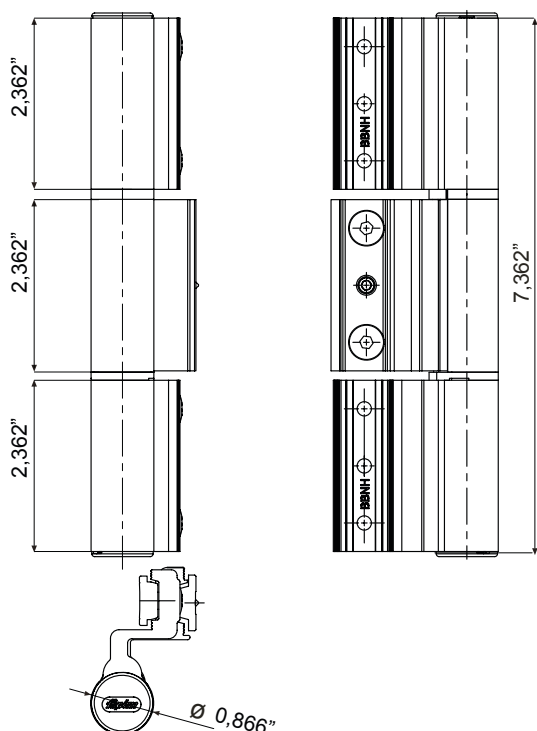
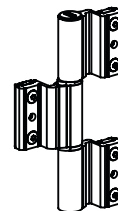
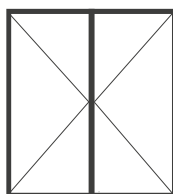

Snap-on cap

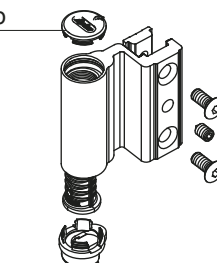

Counterplate
in extruded aluminium
with central safety hole

STEEL **INOX**

Ø0,393" eccentric pin in stainless steel



Ø0,393"

Horizontal micrometric
adjustment with the door closed

Bush in Delrin for pressure adjustment

Grub screw for vertical adjustment
with the door closed

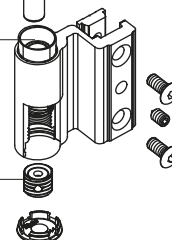

Adjustable

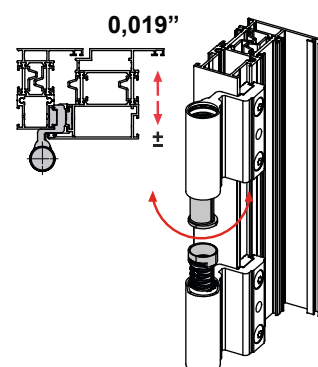
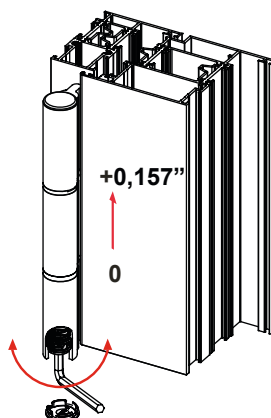
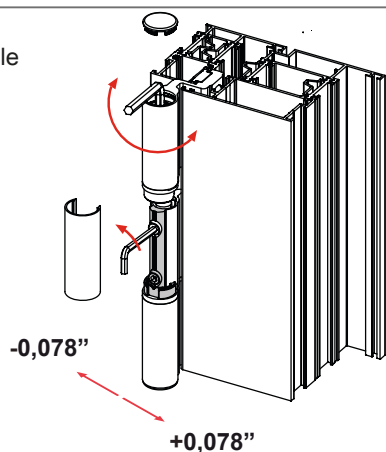

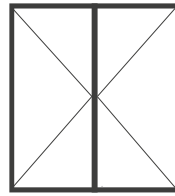

LOIRA+
DOOR SUPPORTING HINGES

352 lb
10.000.000 CYCLES
PATENTED

CE 0497

EN 1935:2002 / AC:2003

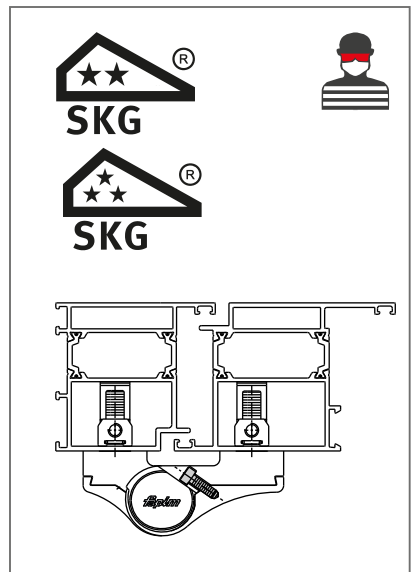
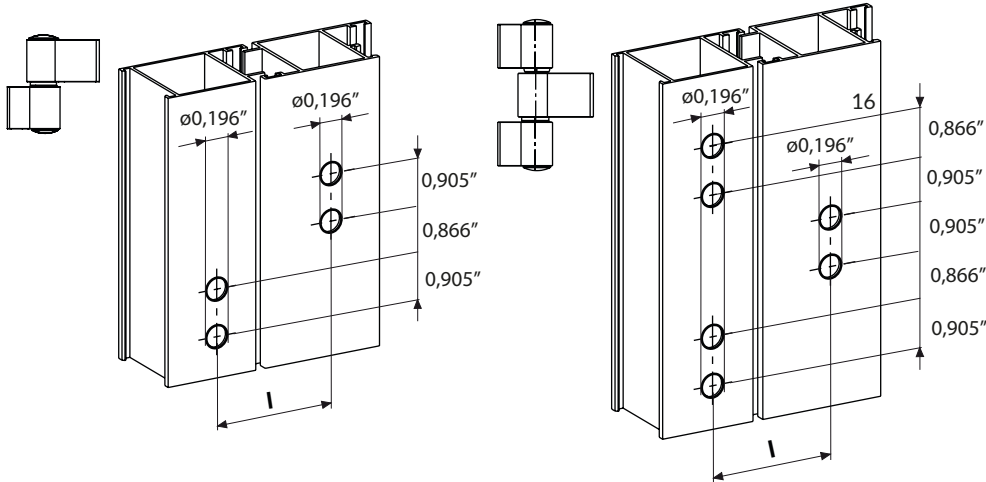

 Adjustable

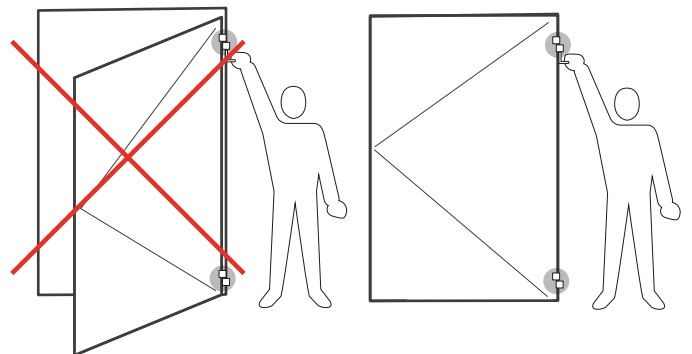
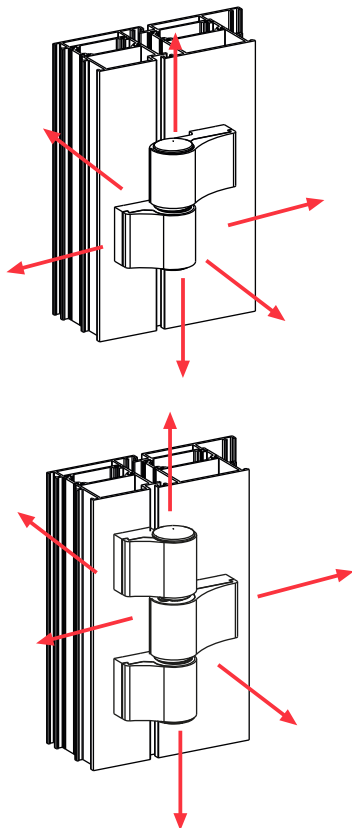

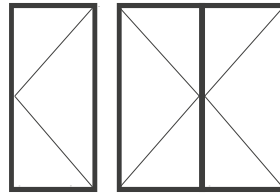

EUROPEAN STANDARD
EN 12209:2003

For multipoint locks the reference standard is the
pr EN15683 project.

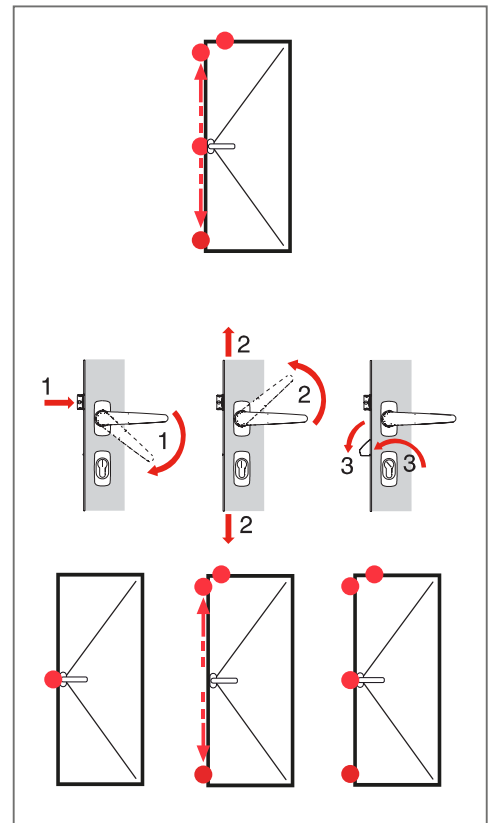
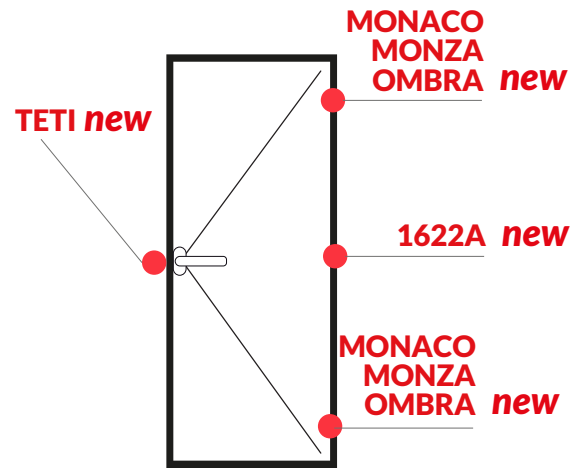
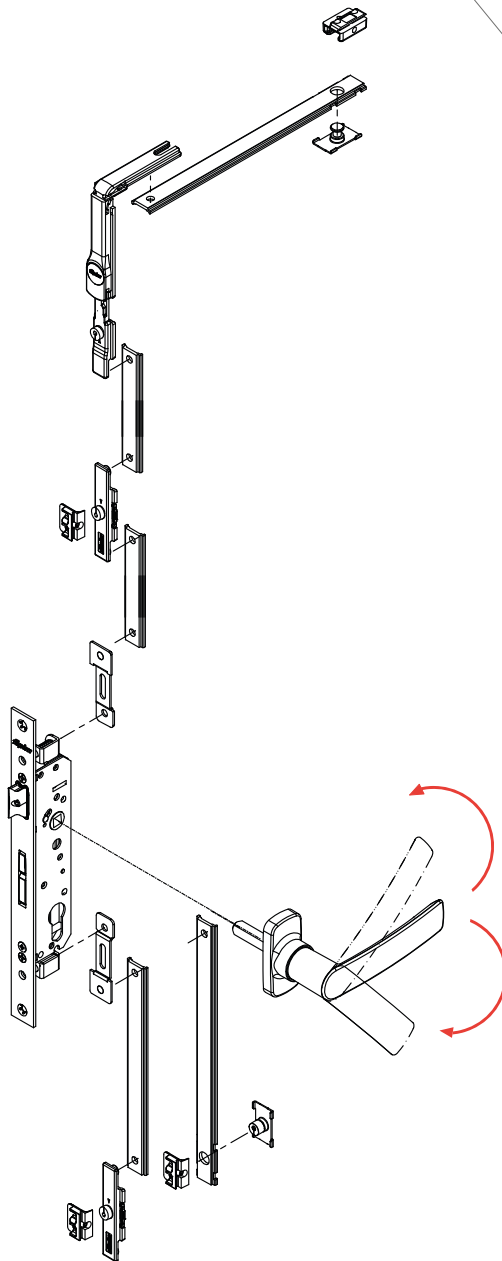
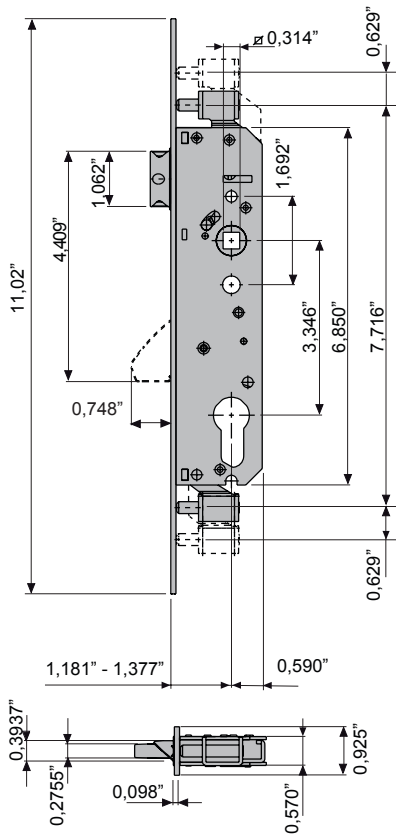

OMBRA DOOR

CONCEALED HINGES

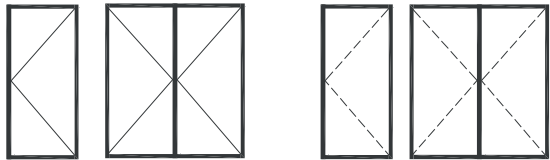

lb 362,5 lb

PATENTED

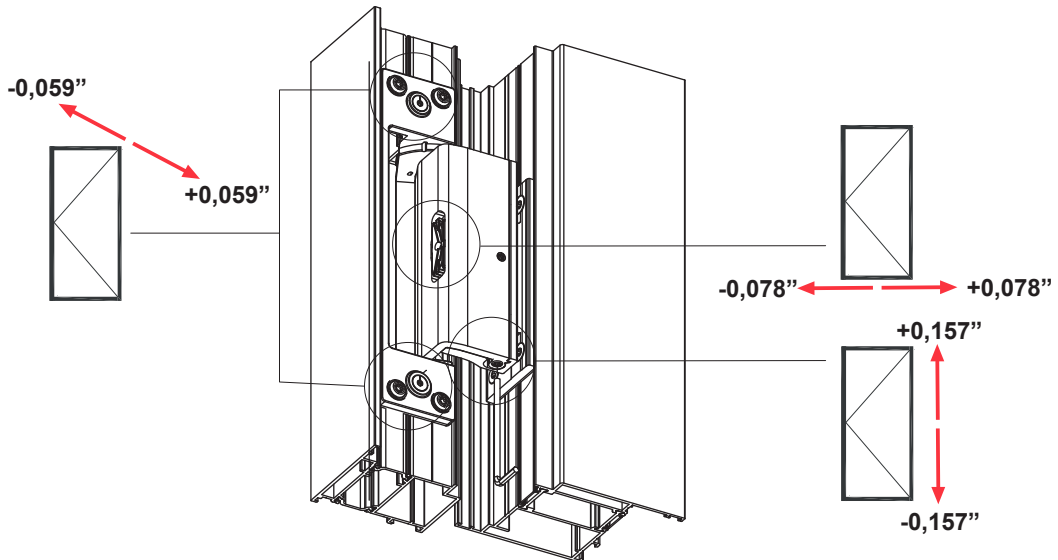
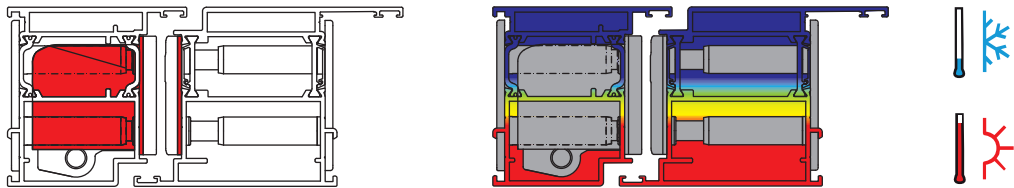
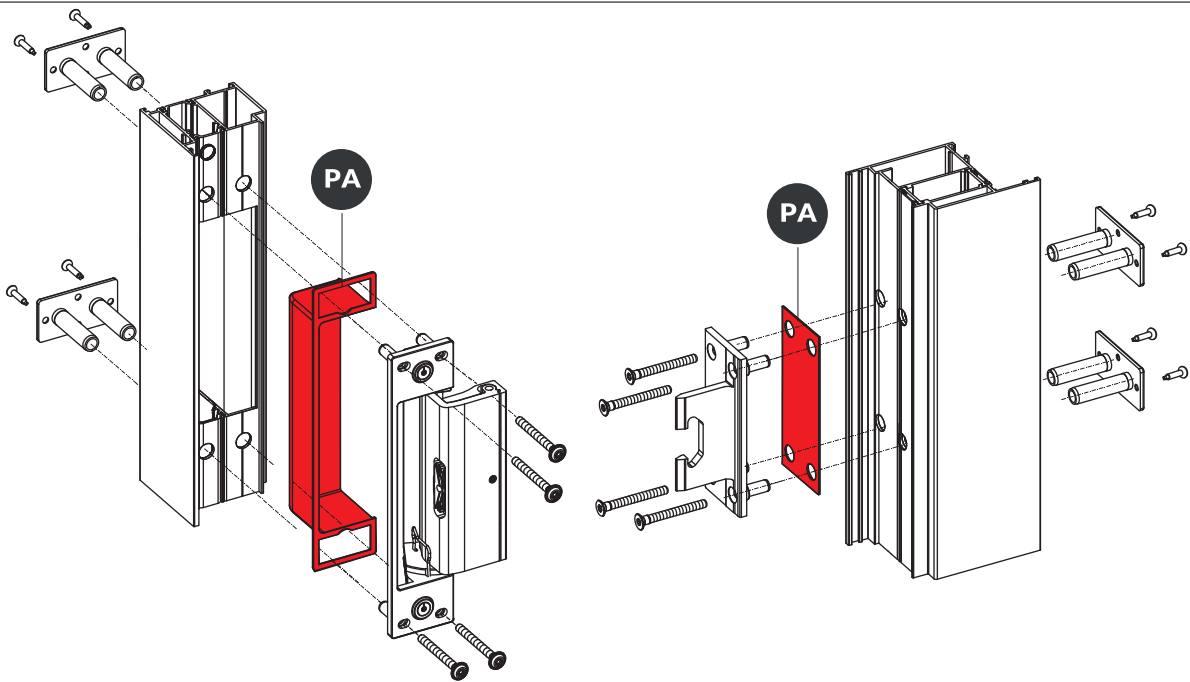

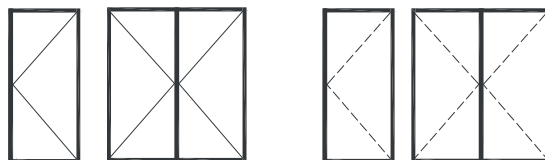
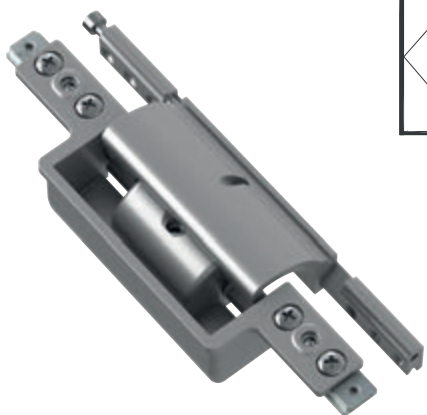

ib 264,5 lb 
PATENTED **C.E.**

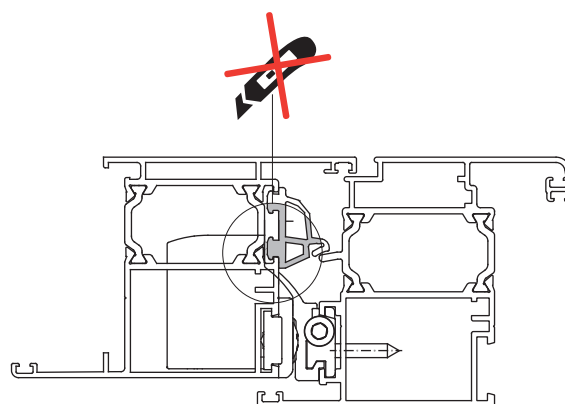
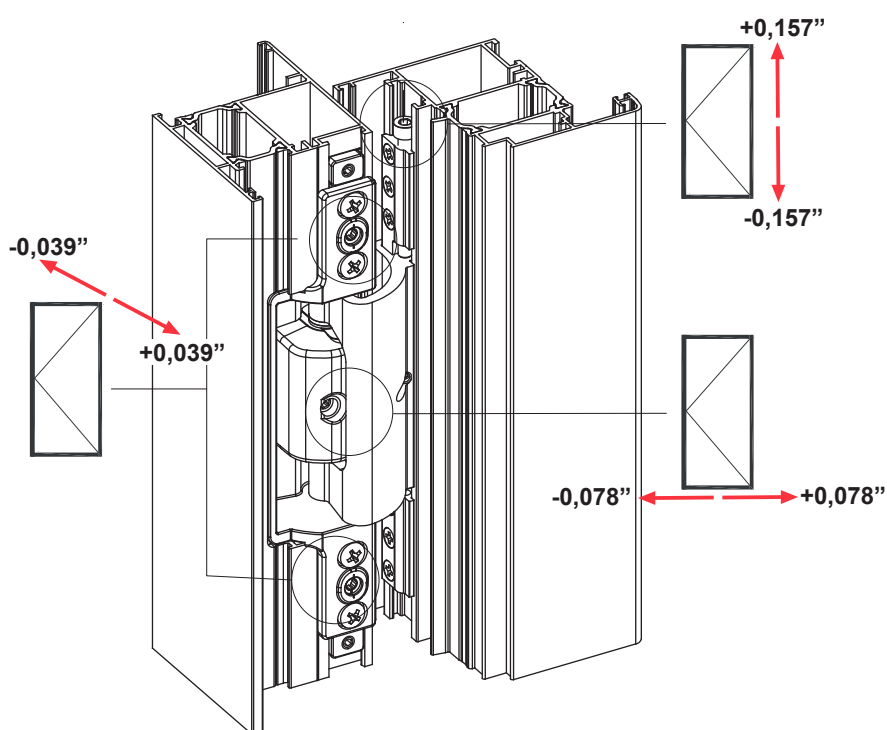
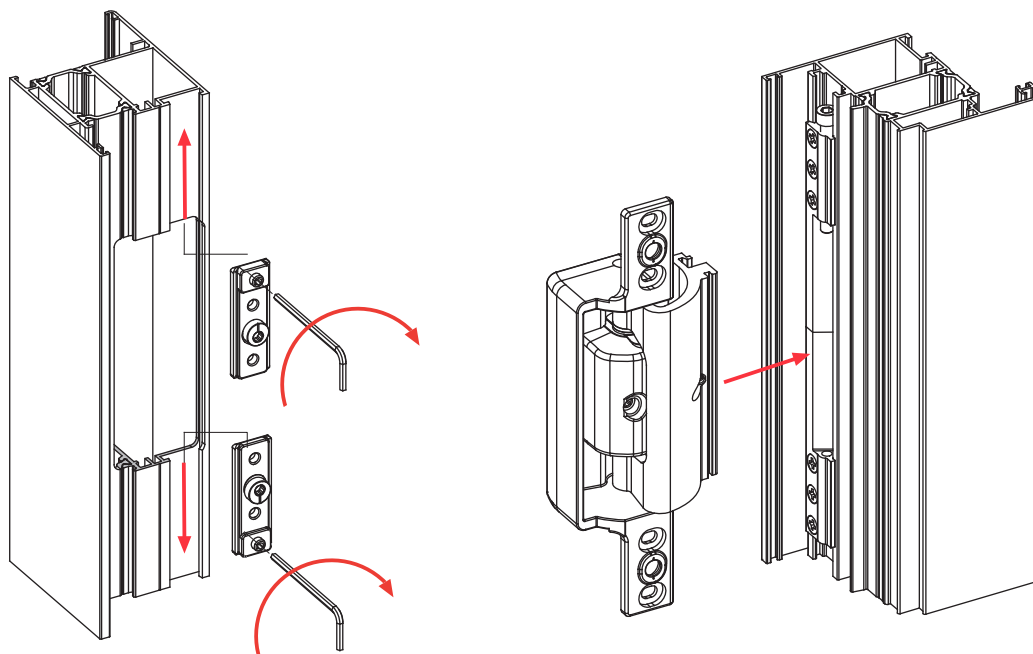

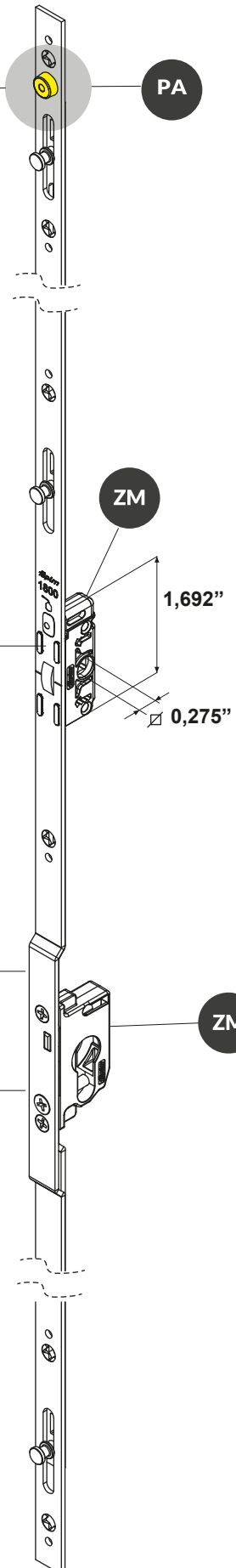
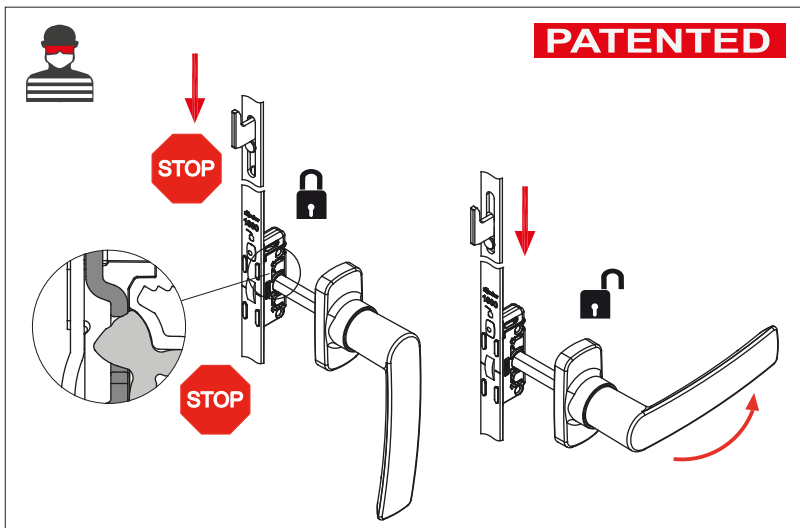
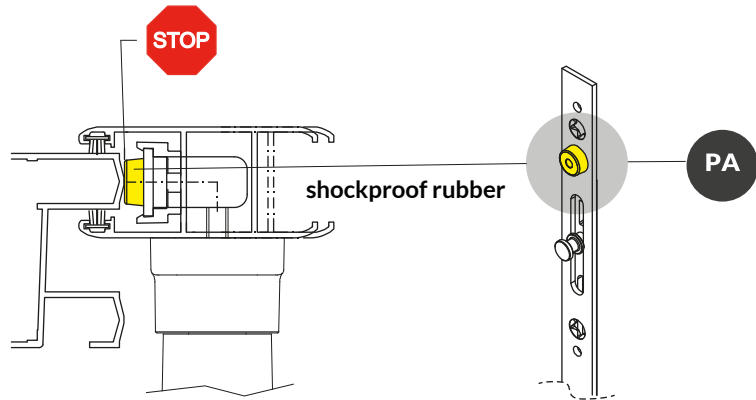
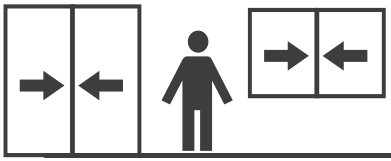

STEEL AISI 304

STEEL ZN

ZM

STEEL INOX

STEEL INOX

PA

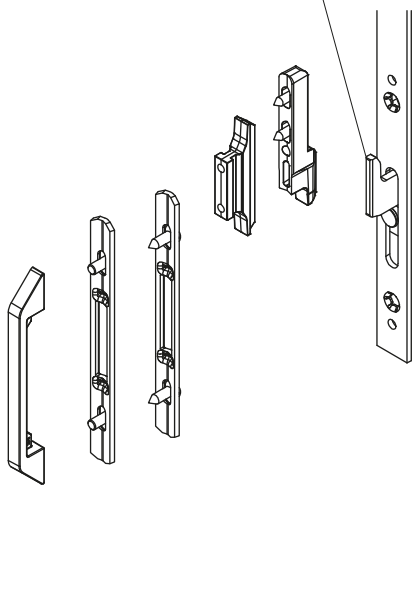

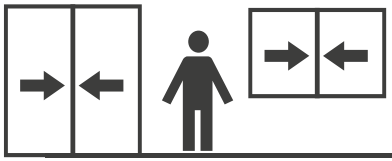

STEEL

ZN



STEEL

INOX

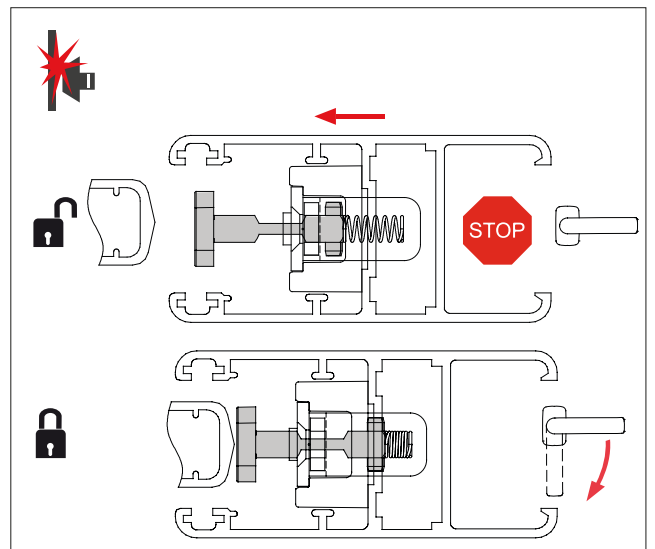
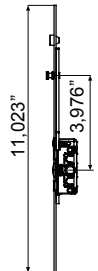
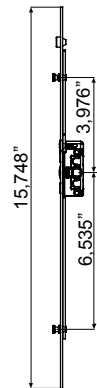
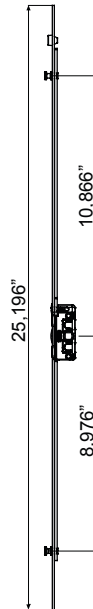
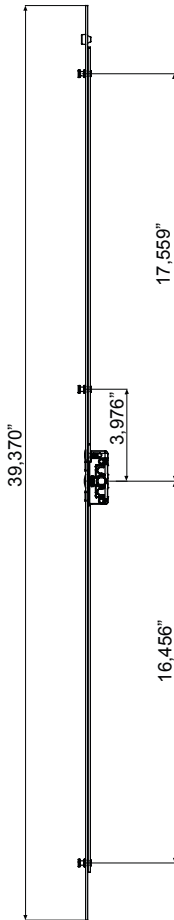
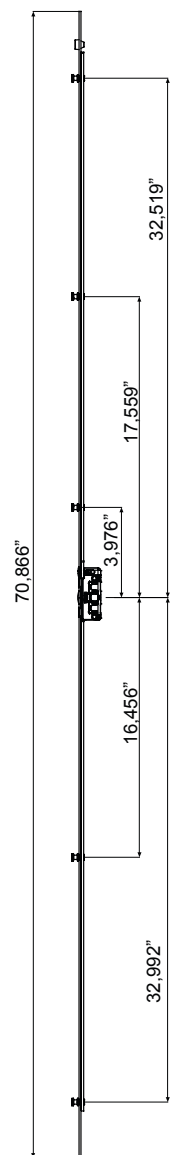
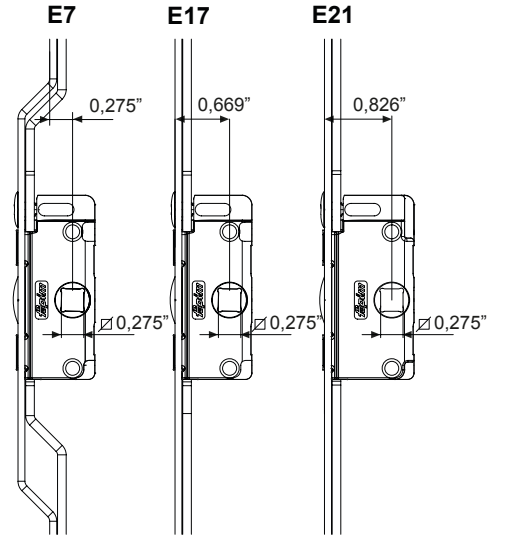
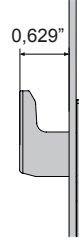
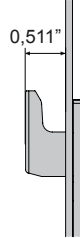
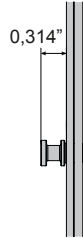

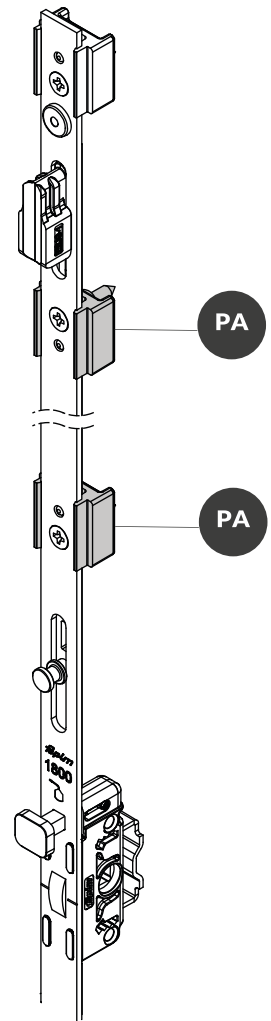
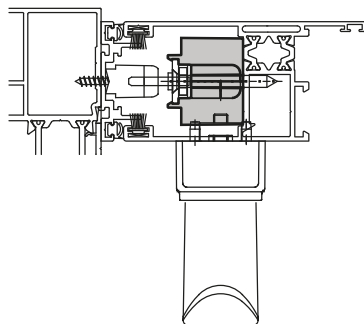
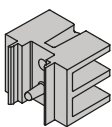
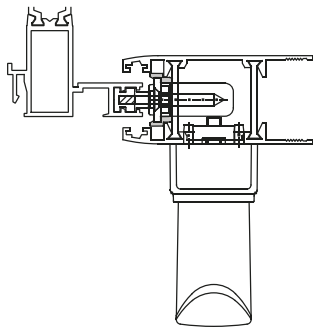
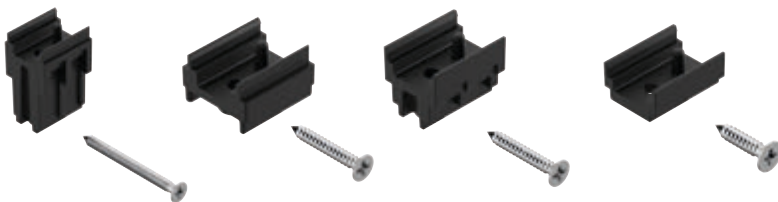
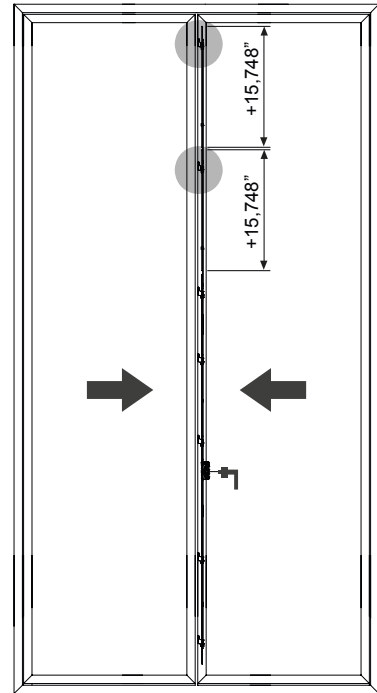
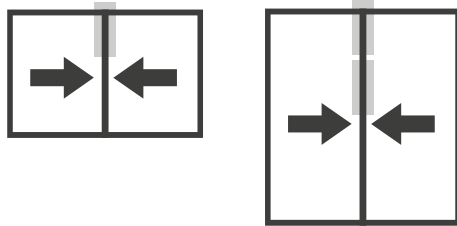
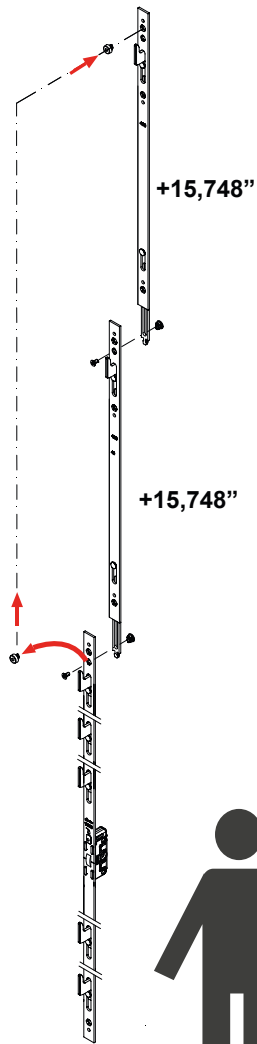
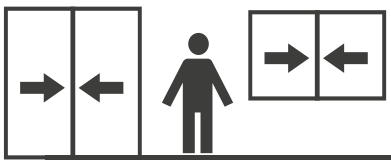

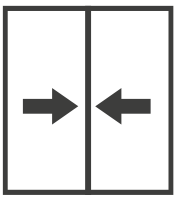

Art. 5040AA-5040AB-5040FA

Art. 5040AL-5040FL

Art. 5040AR-5040FR

Art. 5041A

Art. 5041F

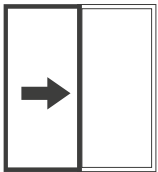
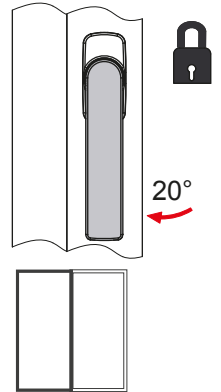
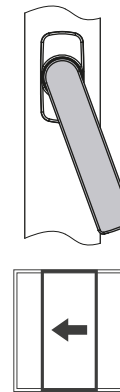
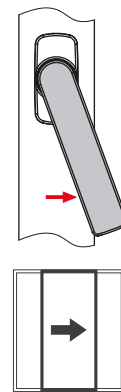
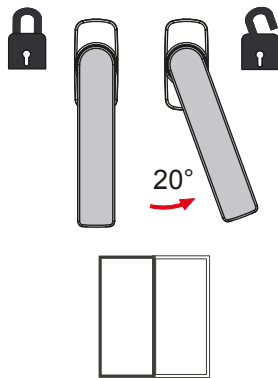

RIGHT

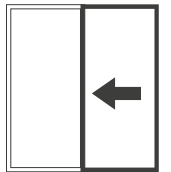
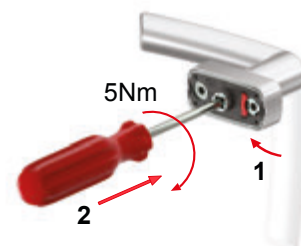
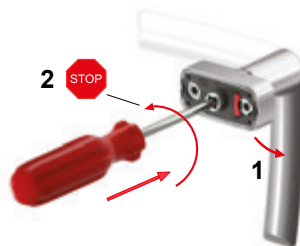
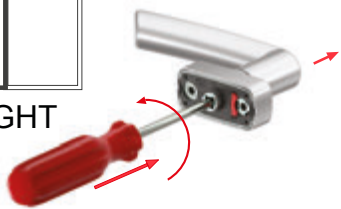

LEFT



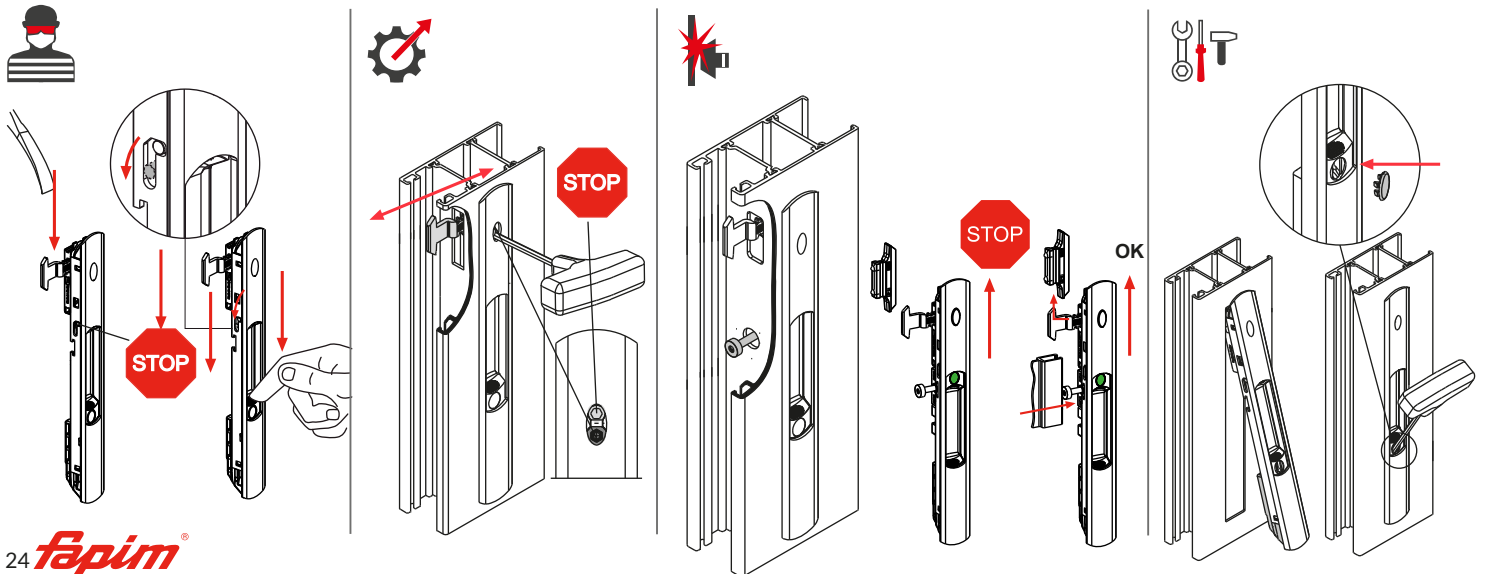
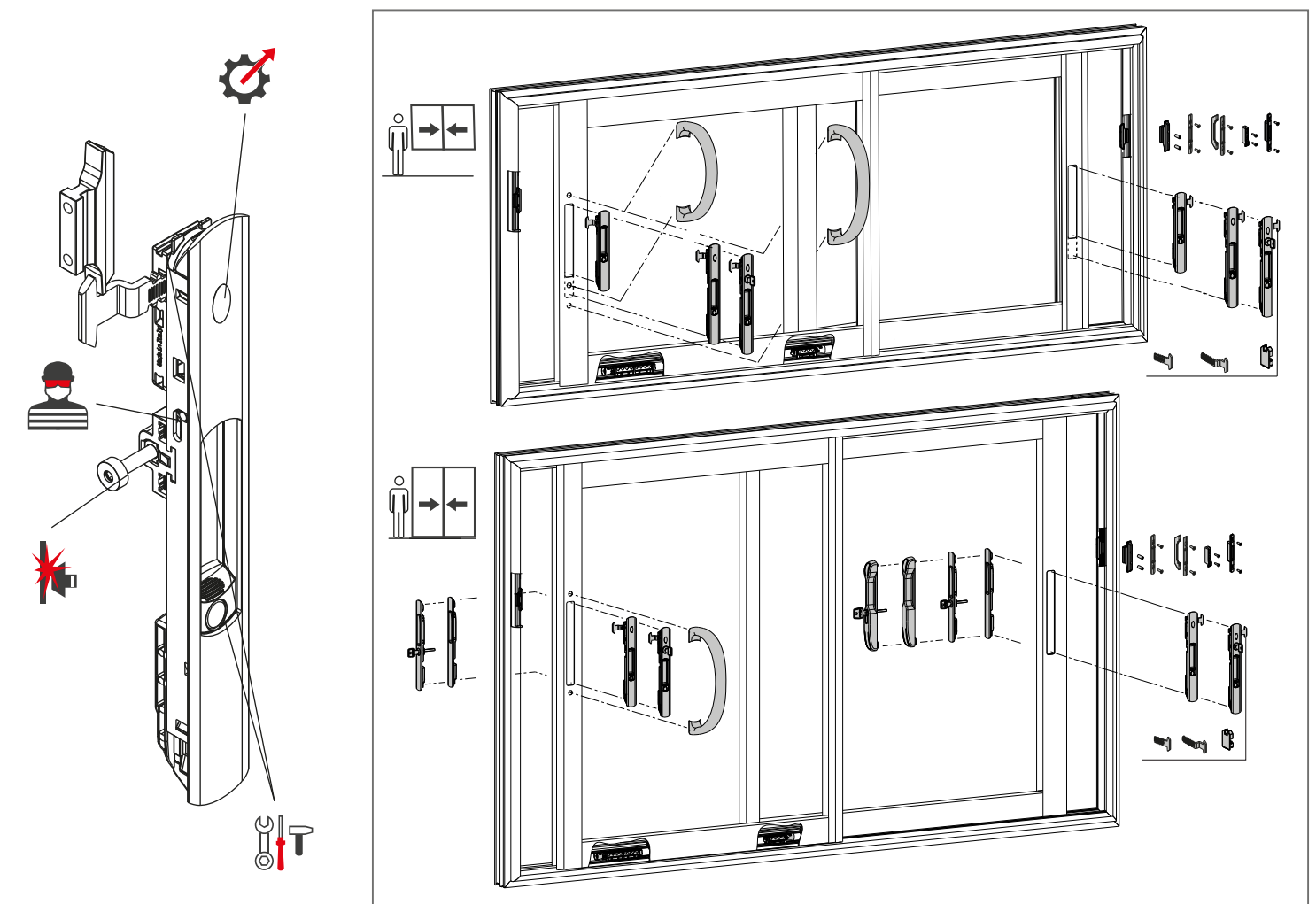
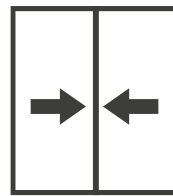

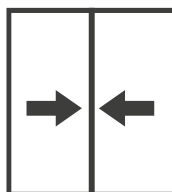

EN13126-15:2008

Durability Test
Static Test
Salt Spray an Corrosion Test

1RR

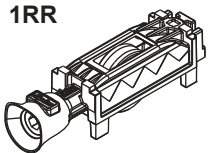

2RR

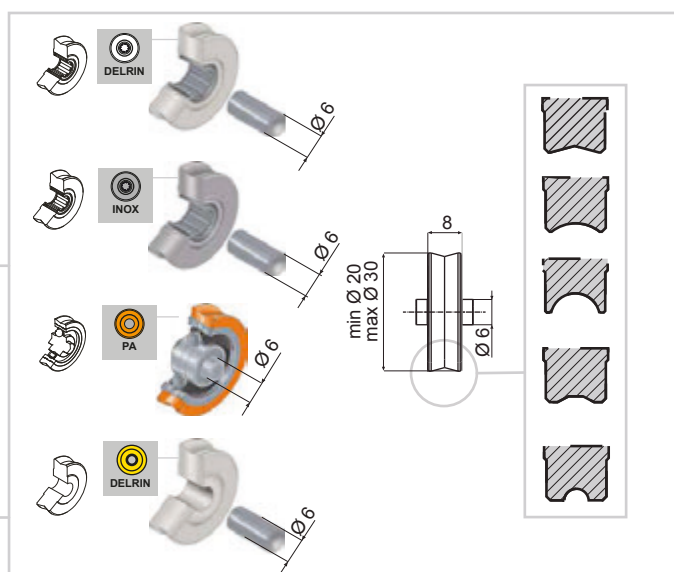
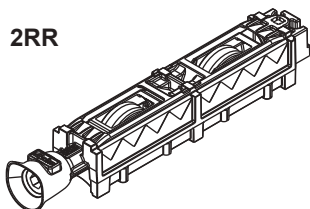

Durability Test	1RR	A	B	C	D	CL. 3	CL. 4	CL. 5	
						10.000 cycles	15.000 cycles	25.000 cycles	
		198,416 lb	176,37lb	154,324lb					
		198,416 lb	176,37lb	154,324lb					
		165,347lb	143,3lb	143,3lb					
		110,231lb	99,208lb	77,1618lb					
		110,231lb	352,74lb	308,647lb					
		396,832lb	352,74lb	308,647lb					
		286,601lb	264,555lb	220,462lb					
		220,462lb	198,416 lb	154,324lb					
Static Test									
	1RR	198,416 lb	198,416 lb	165,347lb	110,231lb				
	2RR	396,832lb	396,832lb	286,601lb	220,462lb				
Salt Spray And Corrosion Test	1RR	A	240 h (Grade 4) UNI EN 1670:2007						
	2RR	C	480 h (Grade 5) UNI EN 1670:2007						
		D							

SURFACE FINISH

31-1013 GLO	32-9010 GLO	34-6005 GLO	35-8017 GLO	43-8019 GLO	58-9016 GLO	76-1015 GLO
61-INOX SGL	MV-INOX SGL	OV-BLACK SGL	QK-9006 SGL	63-6029 GLO	71-3000 GLO	37-9005 MAT
65-BRONZE MAT	70-BROWN MAT	AH-1013 MAT	BN-BRONZE MAT	G5-9006 MAT	MR-7016 MAT	OT-9001 MAT
QM-9010 MAT	QT-9003 MAT	QX-9016 MAT	62-8077 MAT	48 GREY BH	50 GREEN BH	51 BROWN BH
60_GREEN TX	61_BROWN TX	NN_7016 TX				
05-SILVER ADZ	23-BLACK ADZ	06-INOX ADZ	15-GOLD ADZ			
32-9010 GLO	37-9005 MAT	58-9016 GLO	71-3000 GLO	G5-9006 MAT	G6-SILVER SGL	
CLEAN HAND	CLEAN HAND	CLEAN HAND	CLEAN HAND	CLEAN HAND	CLEAN HAND	
03-INOX PVD	16-GOLD PVD					



SURFACE FINISH

The products of the Olimpo line undergo surface treatments according to the highest quality standards, guaranteed by strict in-house tests and process and product certifications. The powder coating uses pigments selected for their high resistance to atmospheric agents and is Qualicoat certified, while the anodizing and galvanising treatments, carried out using state-of-the-art processes and techniques, are Qualanod certified.



fapim[®]

Fapim S.p.A.
Via delle Cerbaie, 114
55011 Altopascio (LU) Italy
T +39 0583 2601 F+39 0583 25291
www.fapim.it info@fapim.it
Cod.Fisc. e Part.I.V.A. 02224030466

DOMATIC[®]

DOMATIC
info@domatic.it www.domatic.it

fapim

BENELUX

Fapim Benelux s.r.l.
Avenue Rue St. Roch , 17
7712 Herseaux Belgium
T +32 56 340548
T +32 56 341960
info@fapimbenelux.be

fapim

HISPANIA

Fapim Hispania s.L.
C/edison, esq. A. Ingeniero
Goicoechea 45600
Parcela, 74
Talavera De la Reina (Espana)
T +34 925 828357
F +34 925 841148
administración@fapimhispania.com
pedidos@fapimhispania.com

fapim

POLSKA

Fapim Polska sp. z o.o.
ul.Przyrzeczne 4 03-107
WarszawaNIP : 536-16-29-437
T +48 227813797
F +48 227811022
Gsm 609022972

fapim

RUSSIA

Fapim RU llc
Kaluzhskaya Region
Province Borovskiy, 99km.
main way "Ukraina", building 4A
T +7 48439 97207
info@fapimru.ru

fapim[®]

ARGENTINA

Fapim Argentina S.A.
CUIT: 30-71206299-8
Calle Gral Alvear N° 411 - 1°
Piso of 1 (B1640EWC) Martinez
Pdo. de San Isidro
Buenos Aires - Argentina
T (+54) (11) 4897-0062
y Líneas Rotativas